



PRODUCT: TJ 6Pak Shock Front & Rear (*Short Arm*)

REV: A | 08-30-2016 | II-1300 Series

READ INSTRUCTIONS IN FULL BEFORE INSTALLATION.

QUESTIONS? CALL 916-631-8071 M-F 7:00 AM – 5:00 PM PST

The MetalCloak experience includes the ease of installation of our products. We design for most contingencies, but installation may be different based on different Jeep condition, configuration and/or year.

We are continually trying to improve our products and instructions – please help us by providing feedback and pictures if you find any part of the instructions that do not match your particular Jeep or are not easily understandable.

If you have any difficulties at all, please give us a call. Thank you and enjoy your MetalCloak Products!

IMPORTANT NOTE: We use Stainless Steel Hardware where possible. Therefore, a tube of Silver Anti-seize is provided and should be used on all bolts—only a small amount is needed.

WARRANTY INFORMATION: This article is sold without warranty expressed or implied. No warranty or representation is made as to this products ability to protect the user from injury or death. The user assumes that risk. The effectiveness, warranty and longevity of this equipment are directly related to the manner in which it is INSTALLED, USED and/or MAINTAINED. THE USER ASSUMES ALL RISK. By purchasing this product and opening the packaging, purchasers expressly acknowledge, understand and agree that they take, select and purchase these MetalCloak products from Armored Works, LLC, its affiliates and distributors and agents as is and with all faults. The entire risk as to the quality and performance of these MetalCloak products is with the purchaser. Working on your vehicle can be a dangerous activity. If you are unsure of what you are doing, please leave mechanical or safety critical work to a skilled mechanic. We take no responsibility for the incorrect use and/or installation of MetalCloak products.

Section 1: Tools & Notes on Installation



Tools Required: This list is the recommended tools for ease of installation. Other versions of the same tool can be used. For example, Allen Wrenches instead of Allen Drive Sockets.



Socket & Ratchet Wrench

14MM Socket 16MM Socket
19MM Socket 3/4" Socket
1/2" Socket



Drill

9/32" Drill Bit



Welder

Electric Cut-off Disc & Grinder



HOW TO USE THIS GUIDE: The installation guide contains ALL steps for installation. Please read and follow the instructions in order of each page top to bottom, and left to right.

Jeep Model: Instructions may apply to multiple Jeep models, but are labeled separately where appropriate (i.e. TJ vs. LJ).

Options: Because of the number of component options we offer, these instructions may contain steps that will not match your particular configuration. You can skip these steps.

Images: Pictures are provided and parts are labeled throughout the instructions. Each text box contains guidance based on the pictures next to it. The text will refer to alphabetical labels (A, B, etc.) found in the images.

Installation Notes: Terms may be used in the body of the instructions that you may not be familiar with, if you have any questions feel free to contact us at the number below, or email techhelp@metalcloak.com

QUESTIONS: Any questions or comments about the instructions? Call us at 916-631-8071 M-F 7:00 AM – 5:00 PM PST.

Section 2: Product Components

DC-0001 REV A

SHEET 1 OF 1

ITEM	PART NUMBER/DESCRIPTION	QTY.
1	AS-0020-BN ORING, .875 X .070 BUNA-N DUR 70A	4
2	AS-0119-BN ORING, .937 X .103 BUNA-N DUR 70A	12
3	AS-0119Q-BN ORING, .937 X .103 BUNA-N DUR 70A	2
4	AS-0150-BN ORING, 3.063 X .103 BUNA-N DUR 70A	2
5	AS-0206-VB ORING, .50 x .139 VITON-BROWN DUR 75A	4
6	AS-0310-BN ORING, .50 X .210 BUNA-N DUR 70A	8
7	FA-2002 SPLIT LOCK WASHER, .312 DIA 18-8 SS	4
8	FA-2004 WASHER, .313ID X .438OD X .062TH PLN STL	8
9	FA-2005 WASHER, .315ID X .937OD X .10TH PLN STL	4
10	FA-2006 PAN HEAD SEAL SCREW, 10-32 X .375L 18-8SS	6
11	FA-2008 SBHCSCREW, .312-24x1.0L ZINC PLTD GR8	4
12	FA-2011 HEX JAM NUT, .312-24 UNF GR 5 PLAIN	4
13	FA-2015-15 THREAD ROD, M5 X 0.8 FEMALE (NOT SHOWN)	6
14	FA-2018 SPLIT LOCK WASHER, M5 HI-COLLAR 18-8 SS	12
15	FA-2019 SHCS, M5-0.8 X 25mm CL 12.9 ZNC PLTD	12
16	SS-0001-13 SHAFT, .50 DIA .312 THRD	4
17	SS-0002 SHAFT BEARING, .50 ID	4
18	SS-0003 PISTON VALVE SEAT, 1.125 DIA	4
19	SS-0005 HOUSING CAP, QUAD TUBE	2
20	SS-0006 WEAR BAND, 1.125 PISTON	4
21	SS-0007 COVER FLANGE, SHOCK	2
22	SS-0008-13 TUBE, SHOCK BODY 1.25 OD	6
23	SS-0010 PISTON, 1.12 ID RESERVOIR	2
24	SS-0013 TANK VALVE, .125 NPT	2
25	SS-0017 TANK VALVE, CAP	2
26	SS-0022 WIPER H SEAL, .5 SHAFT	4
27	SS-0023 TIE MOUNT, SHAFT ENDS, 0.25-18 NPT X 0.5ID	2
28	SS-0027 ROD END, 0.25-18 NPT X .5ID SPHERICAL JOINT	2
29	VS-313-0944-08 VALVE DISKS, .313ID 17-7 SS	8
30	VS-313-0944-15 VALVE DISKS, .313ID 17-7 SS	4

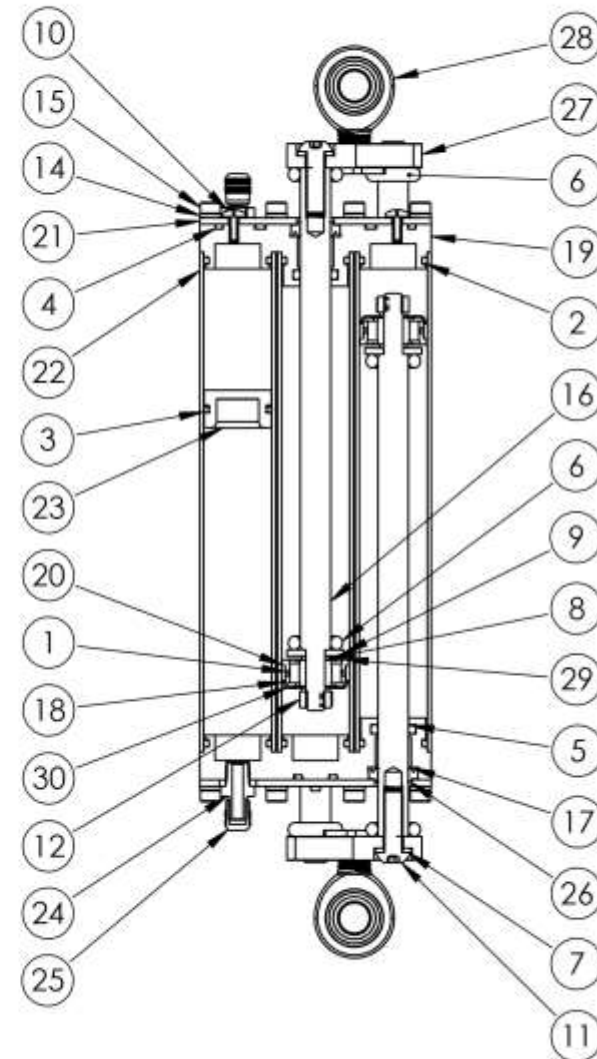

IMPORTANT NOTE



Important Note: All shocks are marked on the top shock plate to identify the shocks corresponding location.

TJF – Front Shocks

TJRD – Rear Driver Side Shock

TJRP – Rear Passenger Side Shock

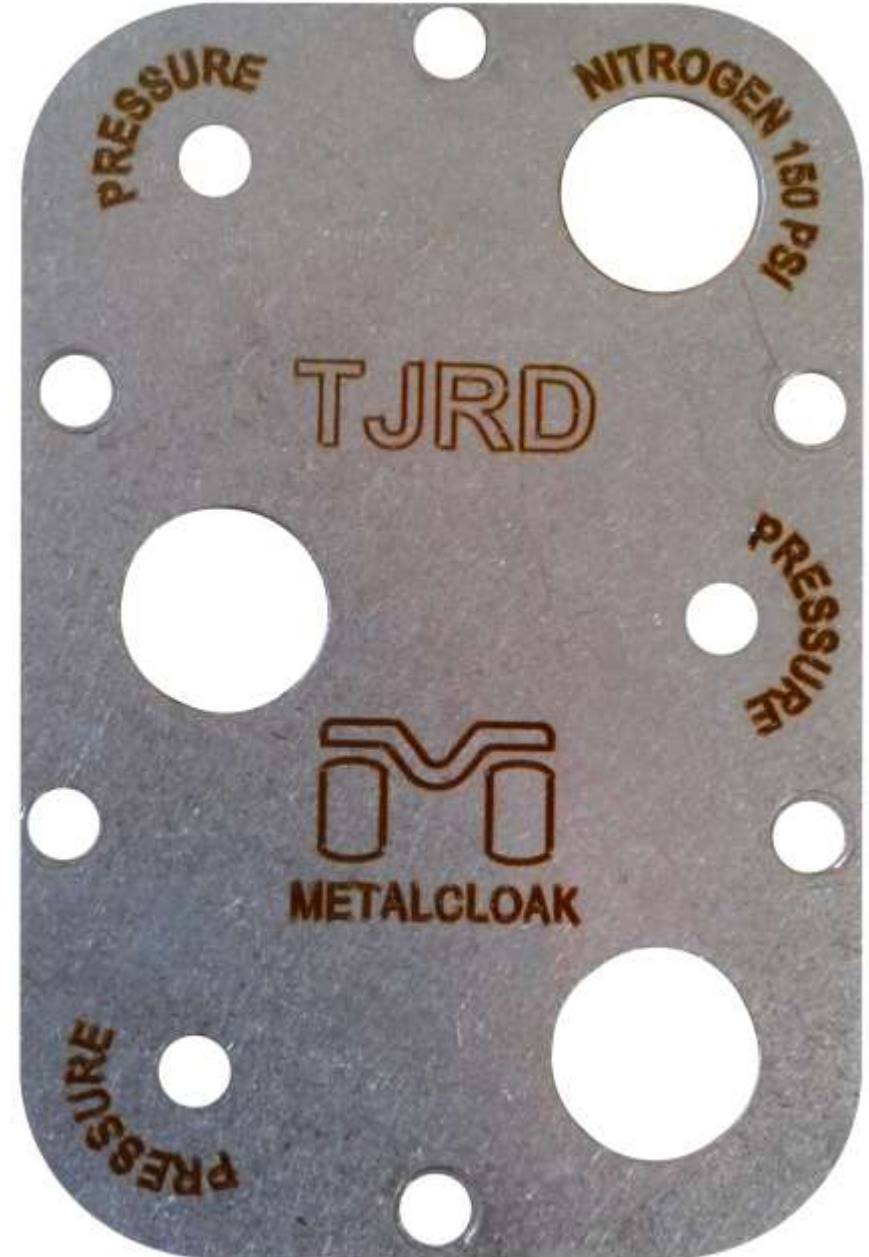

Section 3: Front Shock Installation Instructions



Step 1: Disconnect Stock Shock

- A. Lift Jeep and place jack stands under the front axle before disconnecting anything.
- B. To disconnect the front shocks use a 16MM (5/8") socket and wrench to remove the stock nut on top of the upper shock mount tower.
- C. Use a 19MM (3/4") socket and wrench to remove the stock nut and bolt from the lower shock mount bracket located on the axle.
- D. Remove front shocks.

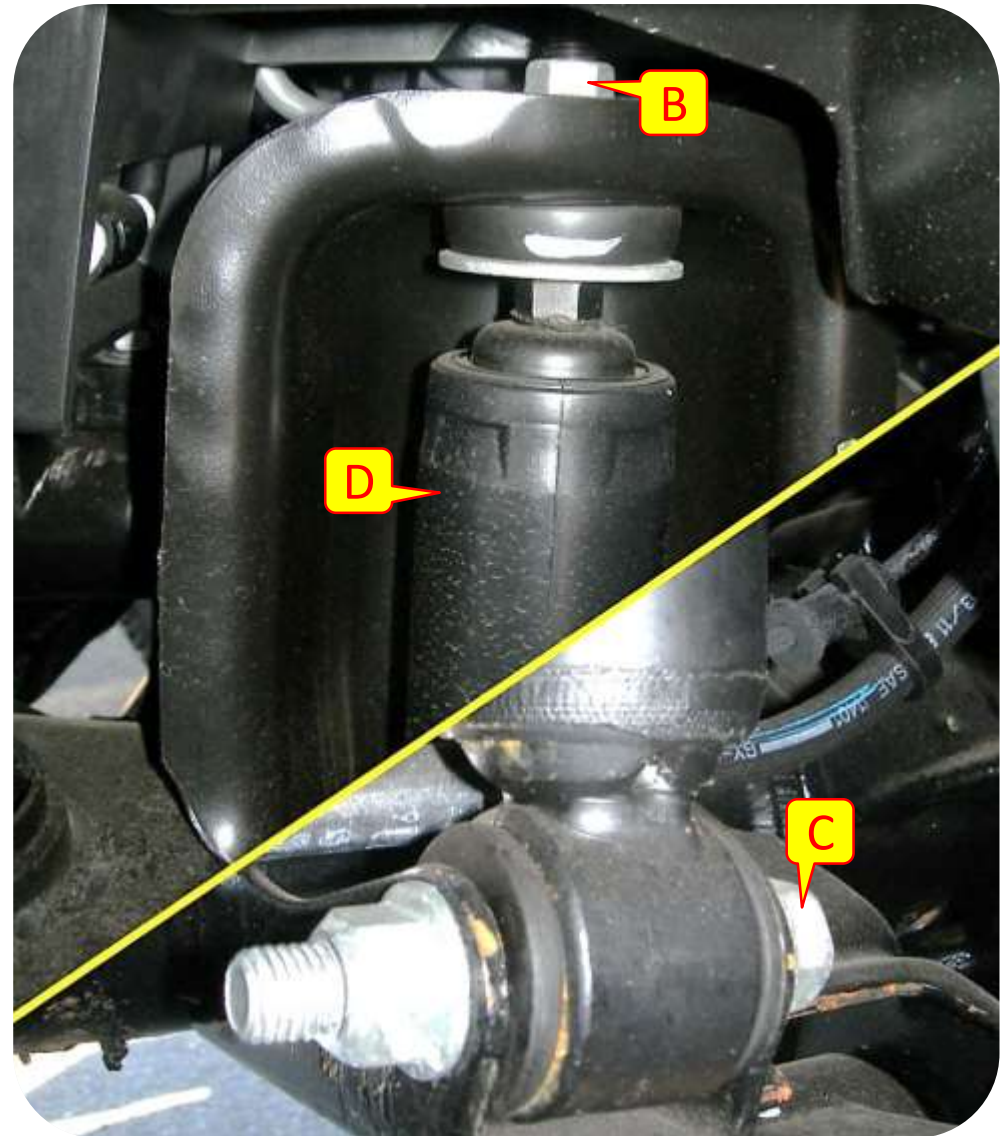

Section 3: Front Shock Installation Instructions



Step 2: Install Upper Front Shock Mount

- Install the threaded stud on the Bracket through the stock location on top of the shock tower; the stud is backed by a 1/2" Washer and Nylon LockNut.
- Orient the Bracket so that the rod-end is mounted OUTBOARD of the stud, and the Bracket itself is centered in the shock tower.
- Using a 3/4" socket tighten the nut on the top of the shock tower.

Note: *The Bushing end of the TJ Front 6Pak Shock mounts to the Upper Front Shock Mount.*

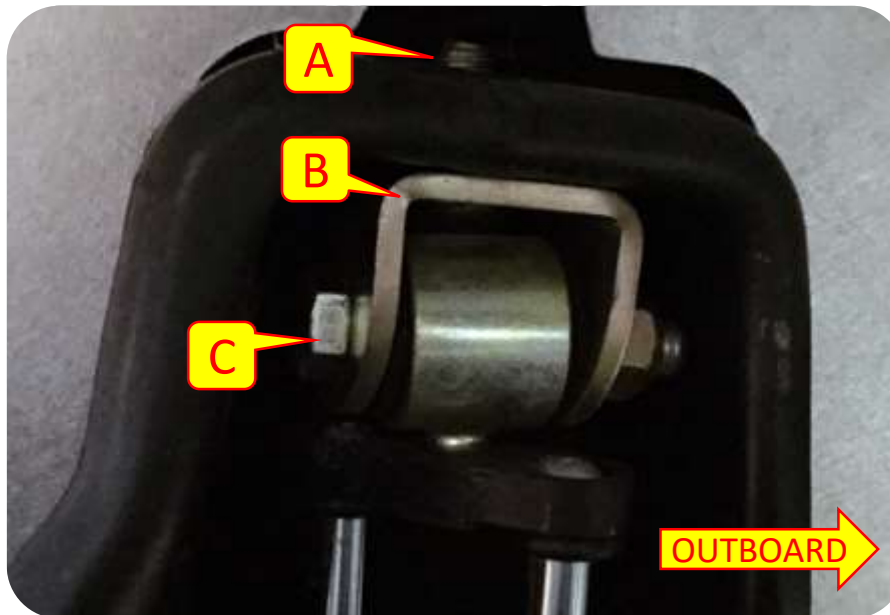

Note: *The red reservoir tubes should be oriented toward the rear of the vehicle.*

Section 3: Front Shock Installation Instructions



Step 3: Install Front Lower Bar Pin Eliminator

- E. Install the Bar Pin Eliminator in the lower 1/2" rod end of the Shock, and use the provided hardware. Tighten bar pin eliminator bolts using a 1/2" socket. Repeat Shock installation on other side.

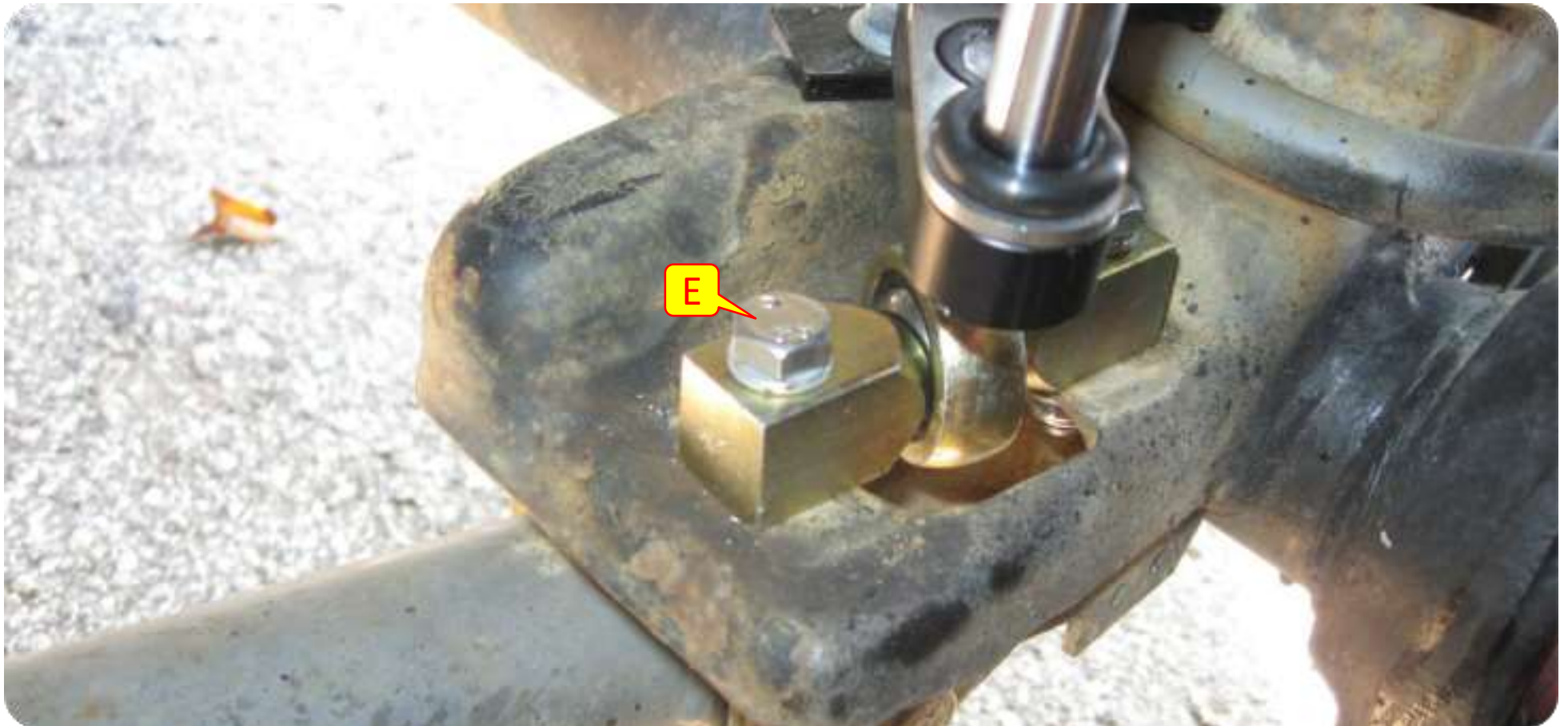

Section 4: Rear Shock Installation Instructions

Step 1: Disconnect Stock Shock

- A. Lift Jeep and place jack stands under the rear axle before disconnecting anything.
- B. To disconnect the Rear shocks use a 19MM (3/4") socket and wrench to remove the stock nut on top of the upper shock mount tower.
- C. Use a 16MM (5/8") socket and wrench to remove the stock nut and bolt from the lower shock mount bracket located on the axle.
- D. Remove rear shocks.
- E. You will need to use a Cut-off Disc or Grinder to remove the stock shock mounts from the axle. Be sure to grind any welds flush to make room for the replacement Lower Shock Mount.

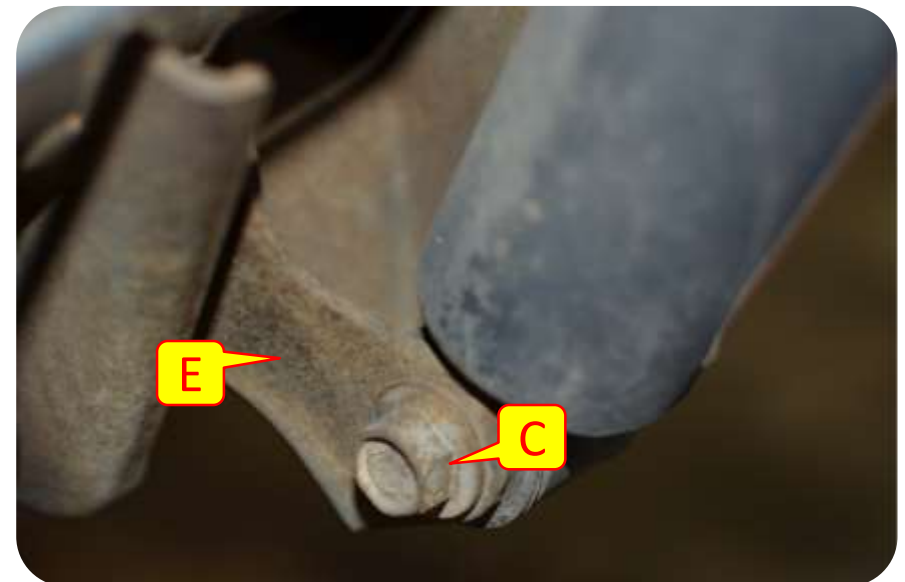
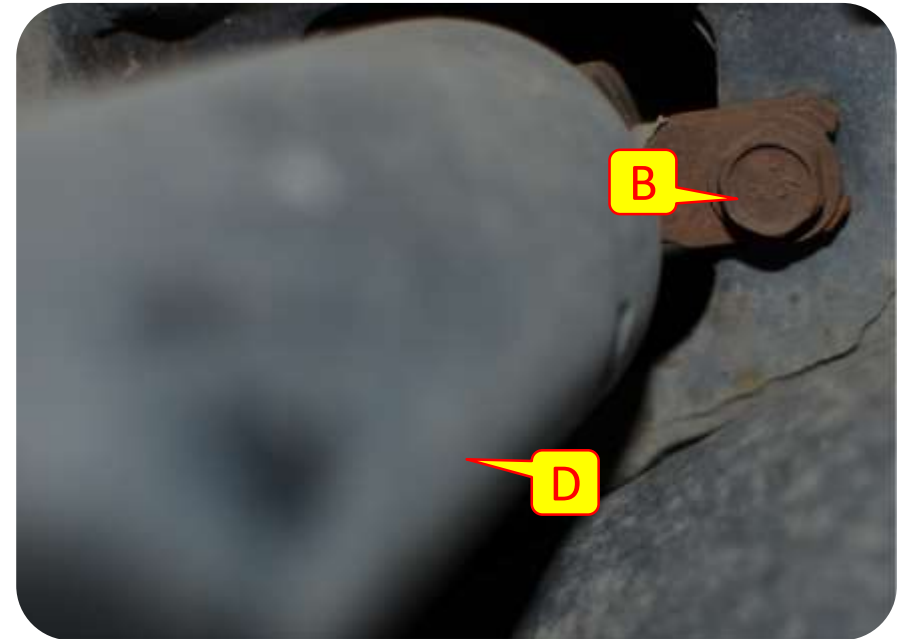

Section 3: Installation Instructions

Step 2: Install Lower Rear Shock Mounts

- A. Align the Lower Shock Mount in the center of the lower control arm bracket on the axle.
- B. To properly clock the Lower Shock Mount make sure the mount is a 1/2" lower than the lower control arm bracket on the axle. *(when the axle is at ride height).*
- C. Weld the bracket in position.
- D. As always, we recommend that you paint all exposed metal to prevent rust.

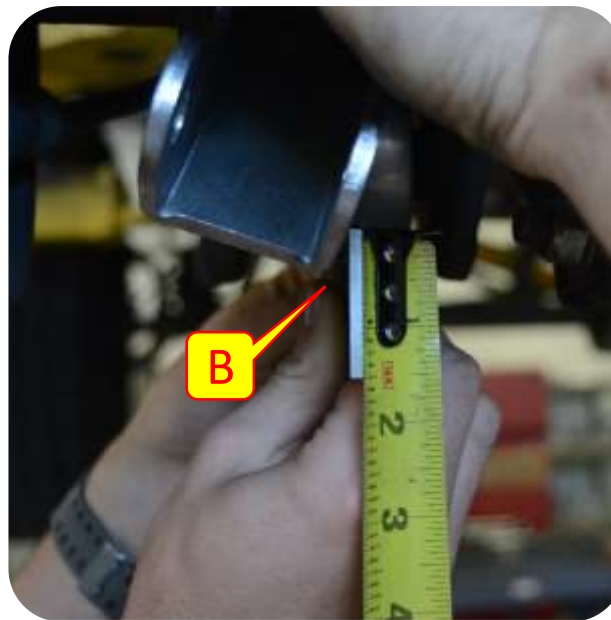

Section 3: Installation Instructions

Step 3: Install Upper Rear Shock Mount

- L. Align the MetalCloak Upper Rear Shock Mount with the factory holes.
- M. Hand tighten the factory hardware to hold the Upper Rear shock mount into place.
- N. Using a 9/32" drill bit drill the additional hole for the third bolt.
- O. Using a 14mm socket tighten down the provided self tapping bolt in the drilled out location.
- P. Tighten all upper rear shock mount bolts.
- Q. Using the provided bolt and spacers install the rear shock in the upper rear shock mount making sure the head of the bolt is away from the frame.
- R. Reinstall the bottom of the shock in the lower rear shock mount.
- S. Tighten down all bolts.

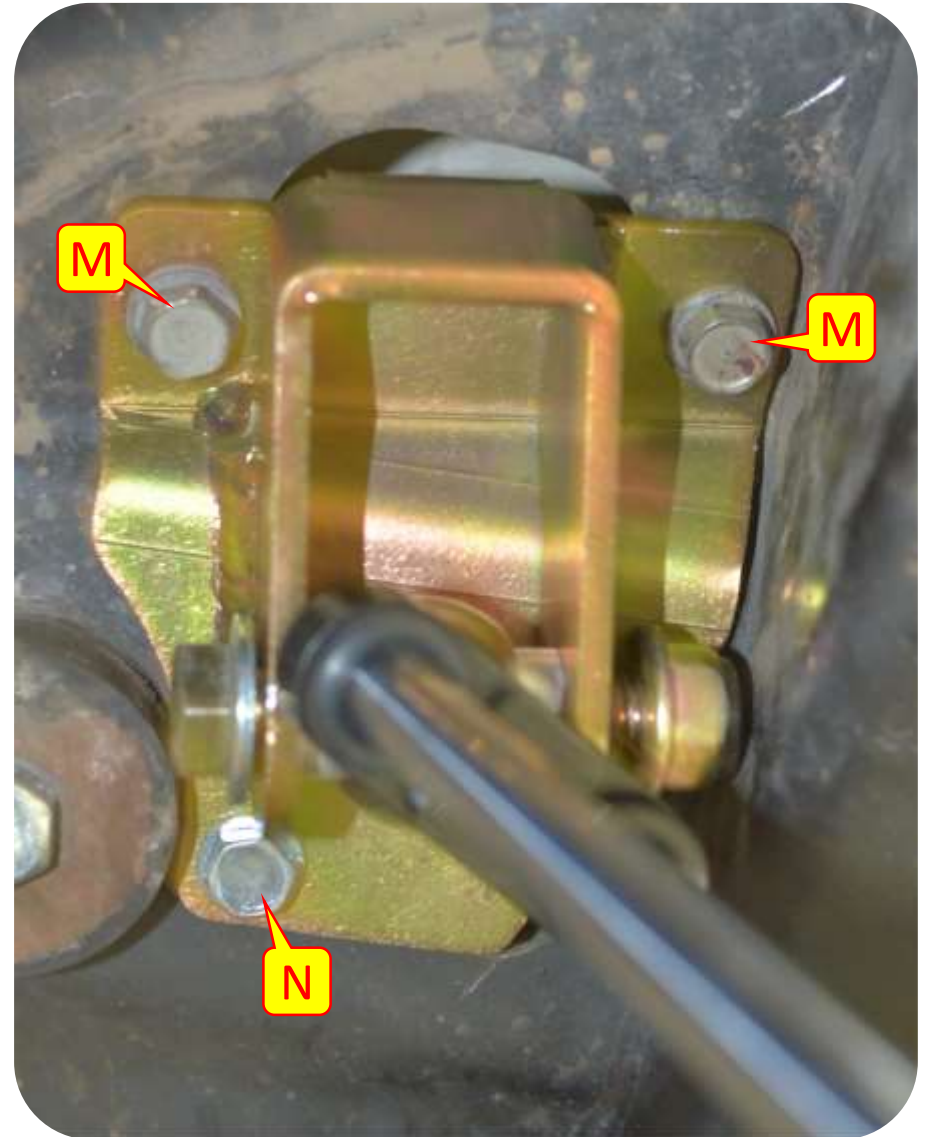

Section 3: Installation Instructions

Step 4: Install Rear Shocks

- A. Install the bushing rod end using the stock hardware.
- B. When properly installed the shocks will roughly parallel to the corners of the gas tank skid, with the reservoirs pointing toward the center of the JEEP. Depending on the fit of your shocks you may find it necessary to trim the stock gas tank skid. Check this fit carefully before driving the vehicle, especially with aftermarket gas tank skids, to ensure you are not rubbing.

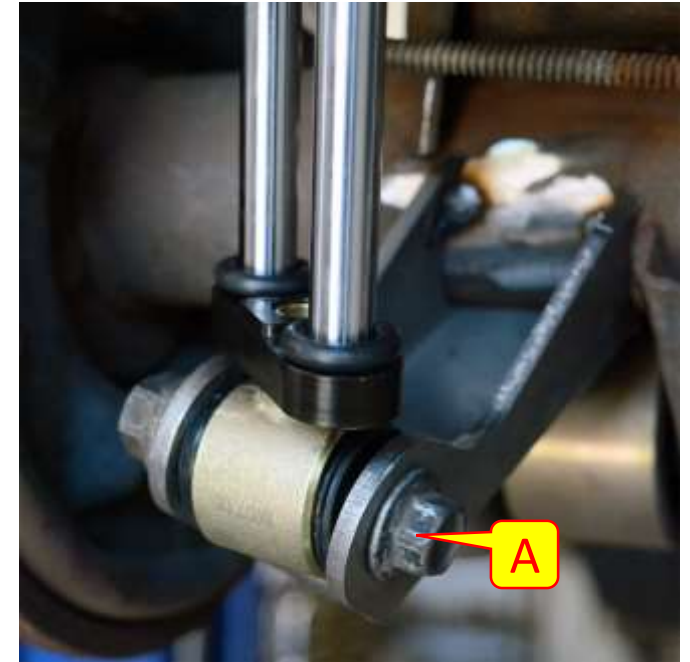

Note: For added clearance, you can trim the stock coil bucket so that it is flush with the rear of the axle. Paint exposed metal.