



PRODUCT: JT Gladiator Front & Rear 6Pak Shocks

REV: A | 03-18-2024 | II-1563

READ INSTRUCTIONS IN FULL BEFORE INSTALLATION.
QUESTIONS? CALL 916-631-8071 M-F 7:00 AM – 5:00 PM PST

The MetalCloak experience includes the ease of installation of our products. We design for most contingencies, but installation may be different based on different Jeep condition, configuration and/or year.

We are continually trying to improve our products and instructions – please help us by providing feedback and pictures if you find any part of the instructions that do not match your Jeep or are not easily understandable.

If you have any difficulties at all, please give us a call. Thank you and enjoy your MetalCloak Products!

WARRANTY INFORMATION: This article is sold without warranty expressed or implied. No warranty or representation is made as to this products ability to protect the user from injury or death. The user assumes that risk. The effectiveness, warranty and longevity of this equipment are directly related to the way it is INSTALLED, USED and/or MAINTAINED. THE USER ASSUMES ALL RISK. By purchasing this product and opening the packaging, purchasers expressly acknowledge, understand and agree that they take, select and purchase these MetalCloak products from Armored Works, LLC, its affiliates and distributors and agents as is and with all faults. The entire risk as to the quality and performance of these MetalCloak products is with the purchaser. Working on your vehicle can be a dangerous activity. If you are unsure of what you are doing, please leave mechanical or safety critical work to a skilled mechanic. We take no responsibility for the incorrect use and/or installation of MetalCloak products.

Section 1: Tools & Notes on Installation



Tools Required: This list is the recommended tools for ease of installation. Other versions of the same tool can be used. For example, Allen Wrenches instead of Allen Drive Sockets. Be sure to use metric on metric and SAE on SAE.



Socket & Ratchet Wrench

3/4" Socket



3/4" Wrench

HOW TO USE THIS GUIDE: The installation guide contains ALL steps for installation. Please read and follow the instructions in order of each page top to bottom and left to right.

Jeep Model: Instructions may apply to multiple Jeep models but are labeled separately where appropriate (i.e. TJ vs. LJ).

Options: Because of the number of component options we offer, these instructions may contain steps that will not match your particular configuration. You can skip these steps.

Images: Pictures are provided and parts are labeled throughout the instructions. Each text box contains guidance based on the pictures next to it. The text will refer to alphabetical labels (A, B, etc.) found in the images.

Installation Notes: Terms may be used in the body of the instructions that you may not be familiar with, if you have any questions feel free to contact us at the number below, or email techhelp@metalcloak.com

QUESTIONS: Any questions or comments about the instructions? Call us at 916-631-8071 M-F 7:00 AM – 5:00 PM PST.

Section 2: Product Components



DC-0001 REV A

SHEET 1 OF 2

	1	2	3	4	5	6	7	8
ITEM	PART NUMBER/DESCRIPTION				QTY.			
E	1	AS-0020-BN ORING, .875 X .070 BUNA-N DUR 70A			4			
	2	AS-0119-BN ORING, .937 X .103 BUNA-N DUR 70A			12			
	3	AS-0119Q-BN ORING, .937 X .103 BUNA-N DUR 70A			2			
	4	AS-0150-BN ORING, 3.063 X .103 BUNA-N DUR 70A			2			
	5	AS-0206-VB ORING, .50 X .139 VITON-BROWN DUR 75A			4			
	6	AS-0310-BN ORING, .50 X .210 BUNA-N DUR 70A			8			
D	7	FM-05110 LOCK WASHER SPLIT, 5.31D X 8.4OD X 1.5TH SS 18-8			12			
	8	FM-05111 SHCS, M5-0.8 X 25L STL C12.9 ZINC			12			
	9	FS-02102 PHCS CROSS SEALING, 10-32 X 0.38L SS 18-8 PLAIN			6			
	10	FS-05099 LOCK WASHER SPLIT, 0.32ID X 0.87OD X 0.08TH SS 18-8			4			
	11	FS-05100 WASHER, 0.31ID X 0.44OD X 0.06TH STL ZINC			8			
	12	FS-05101 WASHER, 0.31ID X 0.94OD X 0.10TH STL			4			
C	13	FS-05103 SBHCS, 0.31-24 X 1.0L STL G8 ZINC			4			
	14	FS-05105 JAM NUT, 0.31-24 X 0.19H STL G5 ZINC			4			
	15	SS-0001-15 SHAFT, .50 DIA .312 THRD			4			
	16	SS-0002 SHAFT BEARING, .50 ID			4			
	17	SS-0003 PISTON VALVE SEAT, 1.125 DIA			4			
	18	SS-0005 HOUSING CAP, QUAD TUBE			2			
B	19	SS-0006 WEAR BAND, 1.125 PISTON			4			
	20	SS-0007 COVER FLANGE, SHOCK			2			
	21	SS-0008-15 TUBE, SHOCK BODY 1.25 OD			6			
	22	SS-0010 PISTON, 1.12 ID RESERVOIR			2			
	23	SS-0013 TANK VALVE, .125 NPT			2			
	24	SS-0016-15 THREAD ROD, M5 X 0.8 FEMALE			6			
A	25	SS-0017 TANK VALVE, CAP			2			
	26	SS-0022 WIPER H SEAL, .5 SHAFT			4			
	27	SS-0023 TIE MOUNT, SHAFT ENDS, 0.25-18 NPT X 0.5ID			2			
	28	SS-0026 FORGED ROD END BUSHING, 0.25-18 NPT X 0.5ID			1			
	29	SS-0027 ROD END, 0.25-18 NPT X .5ID SPHERICAL JOINT			1			
	30	VS-313-0944-08 VALVE DISKS, .313ID 17-7 SS			8			
	31	VS-313-0944-15 VALVE DISKS, .313ID 17-7 SS			4			
	32	VS-313-0944-20 VALVE DISKS, .313ID 17-7 SS			4			

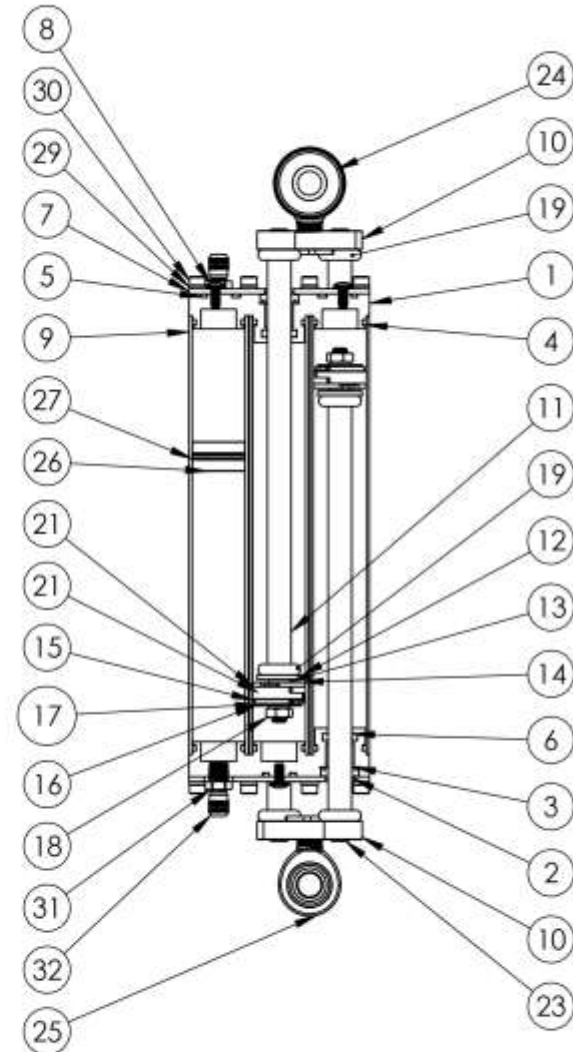

THE INFORMATION CONTAINED ON THIS DRAWING IS THE EXCLUSIVE PROPERTY OF ARMORED WORKS, LLC. UNAUTHORIZED REPRODUCTION IS PROHIBITED.

DO NOT SCALE DRAWING

Metal Cloak
A DIVISION OF ARMORED WORKS, LLC

PART NUMBER
DESCRIPTION

1563 JT 15IN 6PAK ALIGNED REAR

Section 3: Installation Instructions



Step 1: Install Rear 6Pak Shocks

- A. Using the provided hardware install the upper part of the 6Pak Shock (*Bushing End*) making sure to add the washer on the outside of the frame.
- B. Using the provided washer, spacers and hardware install the lower part of the 6Pak Shocks into the stock shock bracket. Make sure the red tubes are facing the front of the Jeep.
- C. Tighten hardware with 3/4" socket and wrench

Important Note: When installing the lower part of the 6Pak on the driver side, make sure to install the provided washer on the inside of the jeep (passenger side of the bracket).

