



PRODUCT: JL Wrangler Stock Bumper Winch Plate Kit

REV: A | 07-05-2023 | II-6110

READ INSTRUCTIONS IN FULL BEFORE INSTALLATION.
QUESTIONS? CALL 916-631-8071 M-F 7:00 AM – 5:00 PM PST

The MetalCloak experience includes the ease of installation of our products. We design for most contingencies, but installation may be different based on different Jeep condition, configuration and/or year.

We are continually trying to improve our products and instructions – please help us by providing feedback and pictures if you find any part of the instructions that do not match your particular Jeep or are not easily understandable.

If you have any difficulties at all, please give us a call. Thank you and enjoy your MetalCloak Products!

IMPORTANT NOTE: We use Stainless Steel Hardware where possible. Therefore, a tube of Silver Anti-seize is provided and should be used on all bolts—only a small amount is needed.

WARRANTY INFORMATION: This article is sold without warranty expressed or implied. No warranty or representation is made as to this products ability to protect the user from injury or death. The user assumes that risk. The effectiveness, warranty and longevity of this equipment are directly related to the manner in which it is INSTALLED, USED and/or MAINTAINED. THE USER ASSUMES ALL RISK. By purchasing this product and opening the packaging, purchasers expressly acknowledge, understand and agree that they take, select and purchase these MetalCloak products from Armored Works, LLC, its affiliates and distributors and agents as is and with all faults. The entire risk as to the quality and performance of these MetalCloak products is with the purchaser. Working on your vehicle can be a dangerous activity. If you are unsure of what you are doing, please leave mechanical or safety critical work to a skilled mechanic. We take no responsibility for the incorrect use and/or installation of MetalCloak products.

Section 1: Tools & Notes on Installation

Tools Required: This list is the recommended tools for ease of installation. Other versions of the same tool can be used. For example, Allen Wrenches instead of Allen Drive Sockets.



Socket & Ratchet Wrench

13mm Socket
18mm Socket

16mm Socket
7/16" Socket



5/32" Allen

T45 Torx Wrench



Vice

Dremel



HOW TO USE THIS GUIDE: The installation guide contains ALL steps for installation. Please read and follow the instructions in order of each page top to bottom, and left to right.

Jeep Model: Instructions may apply to multiple Jeep models, but are labeled separately where appropriate (i.e. TJ vs. LJ).

Options: Because of the number of component options we offer, these instructions may contain steps that will not match your particular configuration. You can skip these steps.

Images: Pictures are provided and parts are labeled throughout the instructions. Each text box contains guidance based on the pictures next to it. The text will refer to alphabetical labels (A, B, etc.) found in the images.

Installation Notes: Terms may be used in the body of the instructions that you may not be familiar with, if you have any questions feel free to contact us at the number below, or email techhelp@metalcloak.com

QUESTIONS: Any questions or comments about the instructions? Call us at 916-631-8071 M-F 7:00 AM – 5:00 PM PST.

Section 2: Product Components

DC-0001 Rev B

SHEET 1 OF 2

ITEM	PART NUMBER/DESCRIPTION	QTY.
1	CP-6925 PLATE MOUNT, STOCK WINCH ADAPTER, JL	1
2	CP-6926 REAR SUPPORT, STOCK WINCH ADAPTER, JL	1
3	WM-6630 WELDMENT, STOCK WINCH ADAPTER BASE, JL	1
HK-6110		
4	FM-08159 NYLOCK NUT, M8-1.25 X 8H STL C8 ZINC	5
5	FS-04005 NYLOCK NUT, 0.25-20 X 0.31H STL GF ZINC	2
6	FS-04021 SBHCS, 0.25-20 X 0.63L SS 18-8 PLAIN	2
7	FS-08127 NYLOCK FLANGE NUT, 0.5-13 X 0.56H STL GF ZINC	4
8	FS-08219 HHCS FLANGE, 0.5-13 X 1.25L STL G8 ZINC	4

D
C
B
A

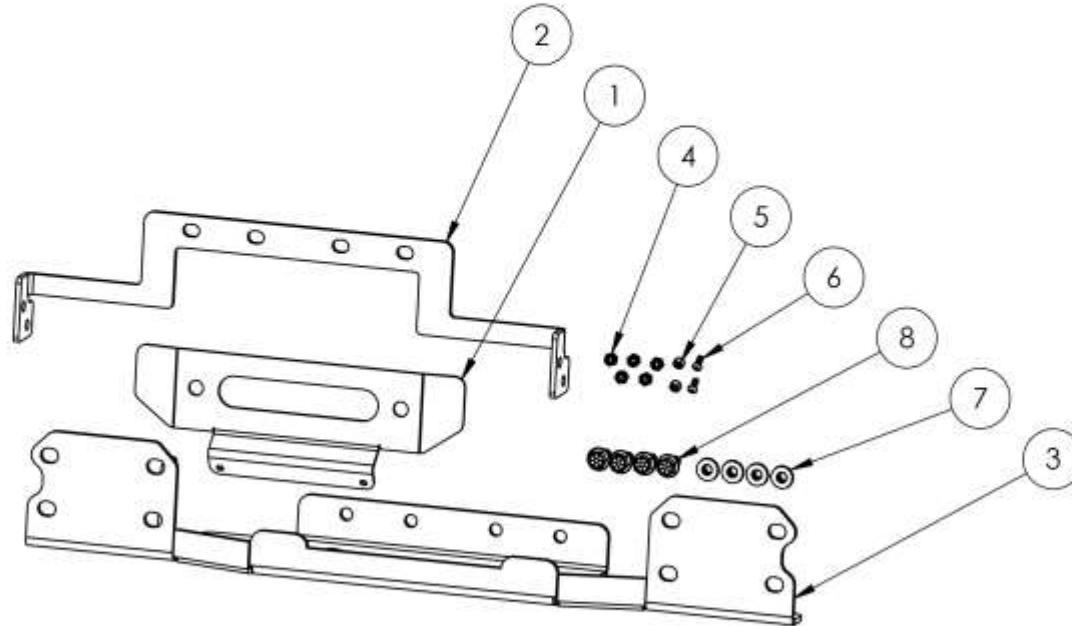

THE INFORMATION CONTAINED ON THIS DRAWING IS THE EXCLUSIVE PROPERTY OF ARMORED WORKS, LLC. UNAUTHORIZED REPRODUCTION IS PROHIBITED.
DO NOT SCALE DRAWING



PART NUMBER/DESCRIPTION
6110 STOCK WINCH ADAPTER BASE, JL

Section 3: Installation Instructions

Step 1: Remove Factory Front Bumper

- A. Disconnect factory fog light bumper wiring harness from the body harness located just behind passenger side bumper mount bolts.
- B. Remove the factory bumper skid with 13mm socket.
- C. Remove lower frame horn mount with 16mm socket, save these bolts for later use.
- D. Remove factory steel bumper with 18mm socket, save these nuts for later use.
- E. Remove the Bumper from the Jeep.

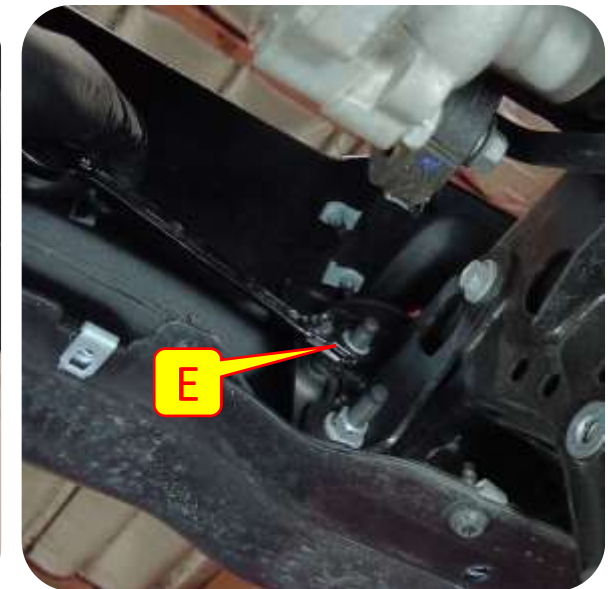
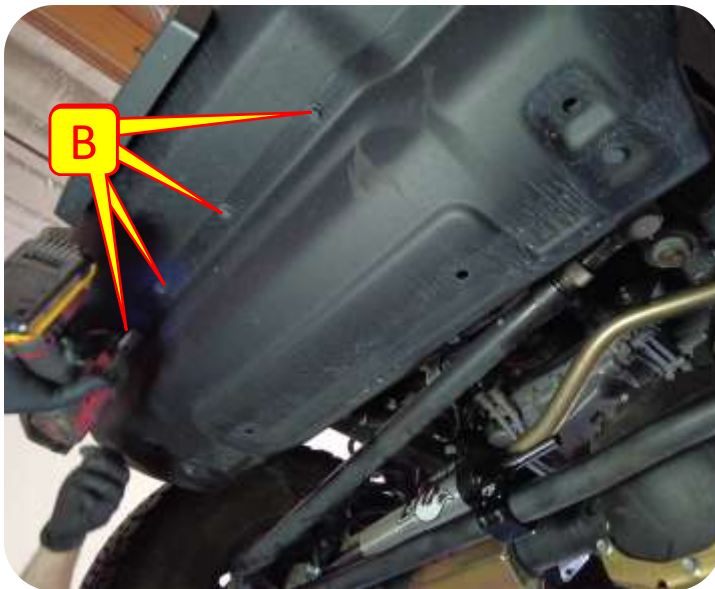
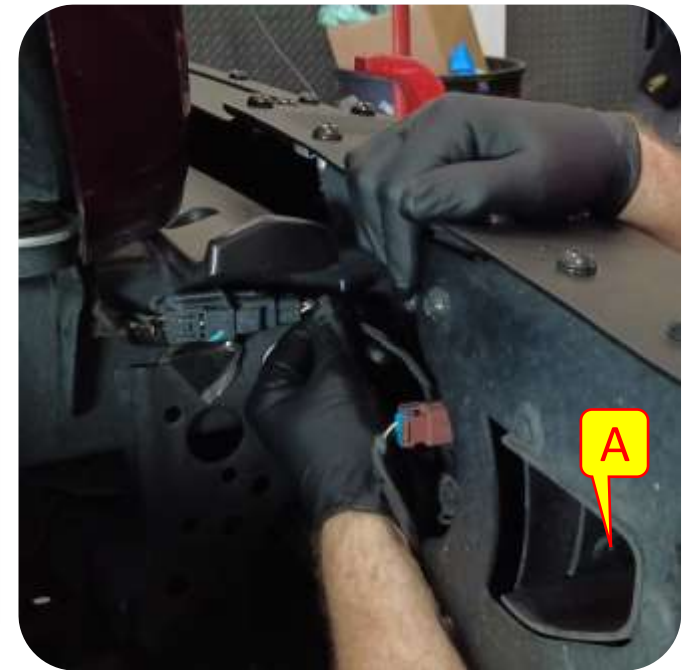

Section 3: Installation Instructions

Step 2: Winch Plate Preparation

- F. Remove cover plate from bumper with T45.
- G. Reinstall factory bolts using provided nuts and tight with T45 and 13mm.
- H. Remove the plastic cover from the front of the factory bumper by pressing on the clips on the back side of the bumper.
- I. Install the license plate to the license plate mount using A 5/32" allen wrench and 7/16" socket.

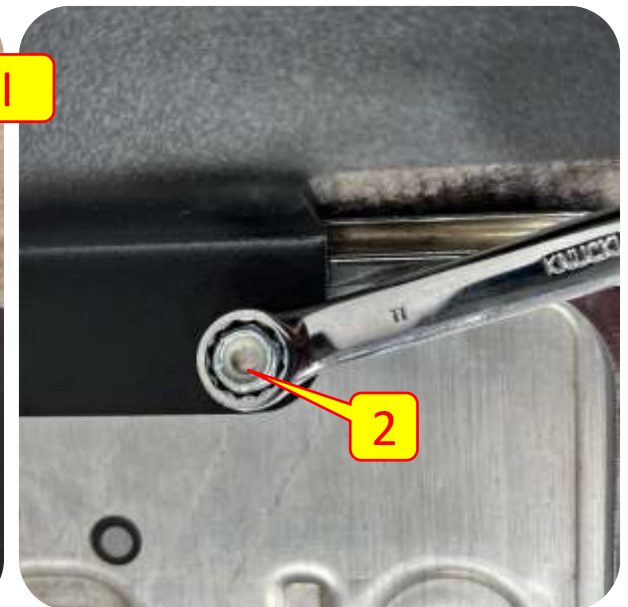
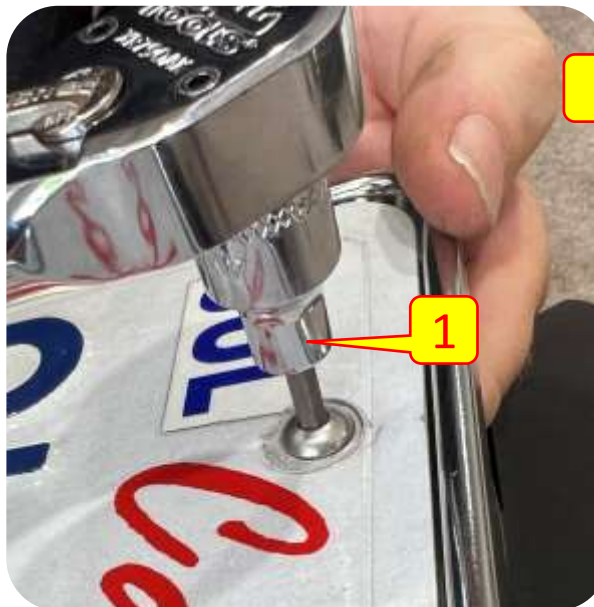
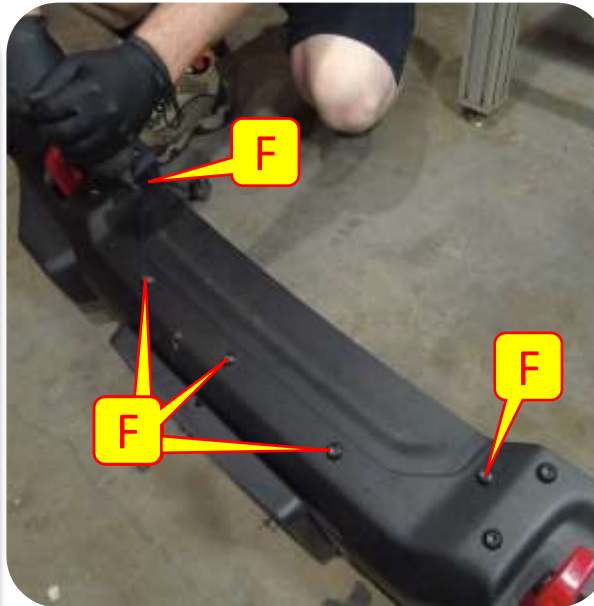

Section 3: Installation Instructions

Step 3: Winch Plate Installation

- J. Using a 5/32" allen and a 7/16" socket or box wrench install the license plate mount and fairlead.
- K. Remove the inner frame horn bracket with a 18mm socket. Save Hardware.
- L. Loosely install winch plate, reusing the factory bolt just removed from frame horn.
- M. Loosely install backing plate using supplied hardware by going underneath and up behind the winch plate.

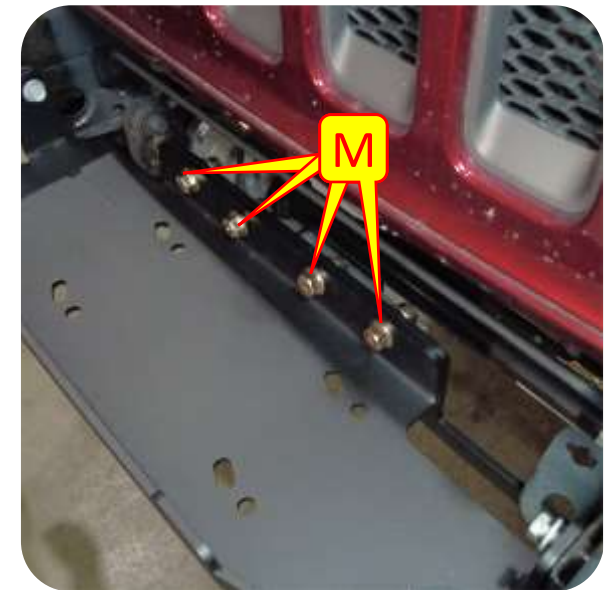
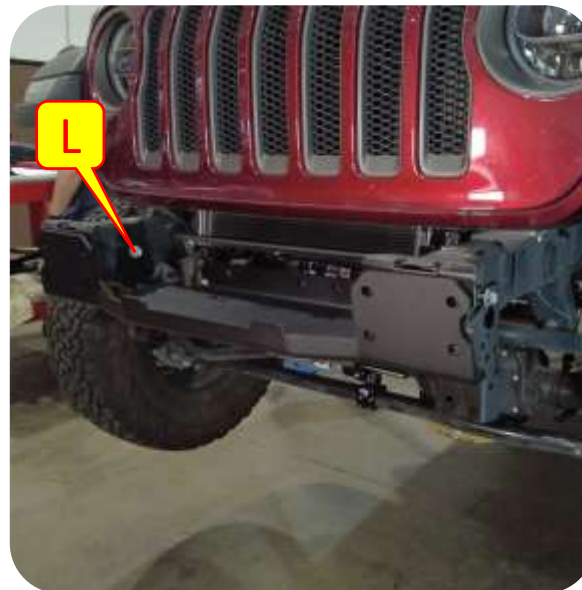
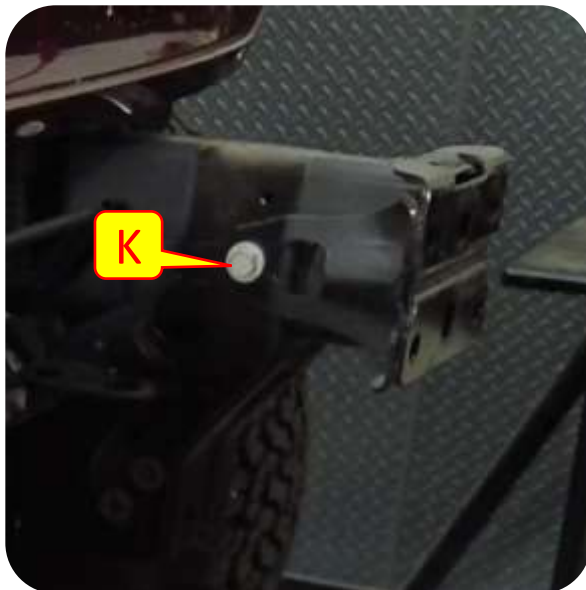

Section 3: Installation Instructions

Step 3: Winch Plate Installation

- N. Modify the frame horn mounts to have slots that extend 1/4" rearward to allow the mount slide to the front for the vehicle when reinstalled to allow reinstallation of the stock bumper skid.
- O. Slide the air dam between the backing plate and the frame on each side and reinstall the air dam factory bolts using a 16mm socket.
- P. Install winch to the bumper cradle using hardware provided with your winch.
- Q. Reinstall factory bumper using the factory bumper bolts and tighten with a 18mm socket.
- R. Install the factory skid reusing the factory bolts and tighten with a 13mm socket.

