



PRODUCT: JL Wrangler Muffler Skid Plate

REV: A | 11-13-2023 | II-6395

READ INSTRUCTIONS IN FULL BEFORE INSTALLATION.
QUESTIONS? CALL 916-631-8071 M-F 7:00 AM – 5:00 PM PST

The MetalCloak experience includes the ease of installation of our products. We design for most contingencies, but installation may be different based on different Jeep condition, configuration and/or year.

We are continually trying to improve our products and instructions – please help us by providing feedback and pictures if you find any part of the instructions that do not match your particular Jeep or are not easily understandable.

If you have any difficulties at all, please give us a call. Thank you and enjoy your MetalCloak Products!

IMPORTANT NOTE: We use Stainless Steel Hardware where possible. Therefore, a tube of Silver Anti-seize is provided and should be used on all bolts—only a small amount is needed.

WARRANTY INFORMATION: This article is sold without warranty expressed or implied. No warranty or representation is made as to this products ability to protect the user from injury or death. The user assumes that risk. The effectiveness, warranty and longevity of this equipment are directly related to the manner in which it is INSTALLED, USED and/or MAINTAINED. THE USER ASSUMES ALL RISK. By purchasing this product and opening the packaging, purchasers expressly acknowledge, understand and agree that they take, select and purchase these MetalCloak products from Armored Works, LLC, its affiliates and distributors and agents as is and with all faults. The entire risk as to the quality and performance of these MetalCloak products is with the purchaser. Working on your vehicle can be a dangerous activity. If you are unsure of what you are doing, please leave mechanical or safety critical work to a skilled mechanic. We take no responsibility for the incorrect use and/or installation of MetalCloak products.

Section 1: Tools & Notes on Installation



Tools Required: This list is the recommended tools for ease of installation. Other versions of the same tool can be used. For example, Allen Wrenches instead of Allen Drive Sockets.



Socket & Ratchet Wrench

15MM Socket
17MM Socket

16MM Socket
9/16" Socket



9/16" Box Wrench

17/32" Drill Bit
Drill (*Plastic Bumper Only*)



HOW TO USE THIS GUIDE: The installation guide contains ALL steps for installation. Please read and follow the instructions in order of each page top to bottom, and left to right.

Jeep Model: Instructions may apply to multiple Jeep models, but are labeled separately where appropriate (i.e. TJ vs. LJ).

Options: Because of the number of component options we offer, these instructions may contain steps that will not match your particular configuration. You can skip these steps.

Images: Pictures are provided and parts are labeled throughout the instructions. Each text box contains guidance based on the pictures next to it. The text will refer to alphabetical labels (A, B, etc.) found in the images.

Installation Notes: Terms may be used in the body of the instructions that you may not be familiar with, if you have any questions feel free to contact us at the number below, or email techhelp@metalcloak.com

QUESTIONS: Any questions or comments about the instructions? Call us at 916-631-8071 M-F 7:00 AM – 5:00 PM PST.

Section 2: Product Components

ITEM	PART NUMBER/DESCRIPTION	QTY.
1	8999 INSTALLATION TOOL, 0.38-16 RIVET NUT	1
2	WM-3727 WELDMENT, MUFFLER SKID, GAS 3.6 2.0 JL	1
3	WM-3728 WELDMENT, MOUNT MUFFLER SKID GAS 3.6 2.0	1
4	WM-3728-P WELDMENT, MOUNT, MUFFLER SKID GAS 3.6 2.0	1
HARDWARE KIT		
5	FM-10213 HHCS, M10-1.5 X 40L STL C10.9 ZINC, FULL THREAD	2
6	FS-06015 HHCS, 0.38-16 x 1.5L STL G8 GOLD ZINC, FULL THREAD	1
7	FS-06031 HHCS, 0.38-16 X 1.0L STL G5 ZINC	2
8	FS-06049 RIVET NUT, 0.38-16 X 0.31GRIP STL G5 GOLD ZINC	2
9	FS-06142 WASHER, 0.41ID X 1.0OD X 0.09TH STL ZINC	2
10	FS-06210 NYLOCK FLANGE NUT, 0.38-16 X 0.41H STL GF ZINC	2

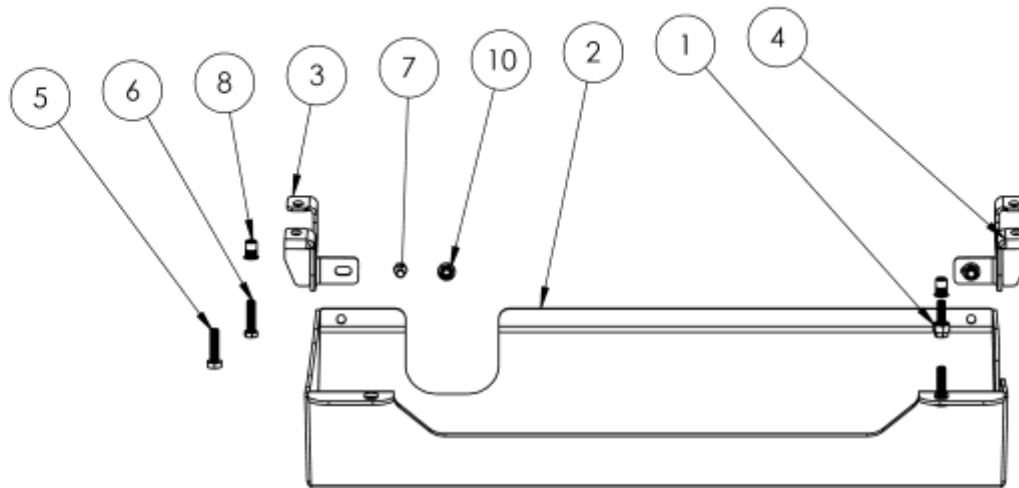

THE INFORMATION CONTAINED ON THIS DRAWING IS THE EXCLUSIVE PROPERTY OF ARMORED WORKS, LLC. UNAUTHORIZED REPRODUCTION IS PROHIBITED.

DO NOT SCALE DRAWING

Metal Cloak
A DIVISION OF ARMORED WORKS, LLC

PART NUMBER/DESCRIPTION

6395 MUFFLER SKID, GAS 3.6 2.0, JL

Section 3: Installation Instructions

Step 1: Plastic Bumper Note

Note: *If you have a plastic bumper you will need to install the provided rivet nut at the two hex head locations (A) at the cross member. You may need to drill the holes out to 17/32"*



Section 3: Installation Instructions

Step 2: Muffler Skid Installation

- A. Using a 16mm socket disconnect the two rear bumper bolts. If you have a plastic bumper see note.
- B. Using a 15mm socket disconnect the rear sway bar bolts.
- C. Insert the provided skid hangers on top of the sway bar mount and loosely install the stock sway bar mount bolts.

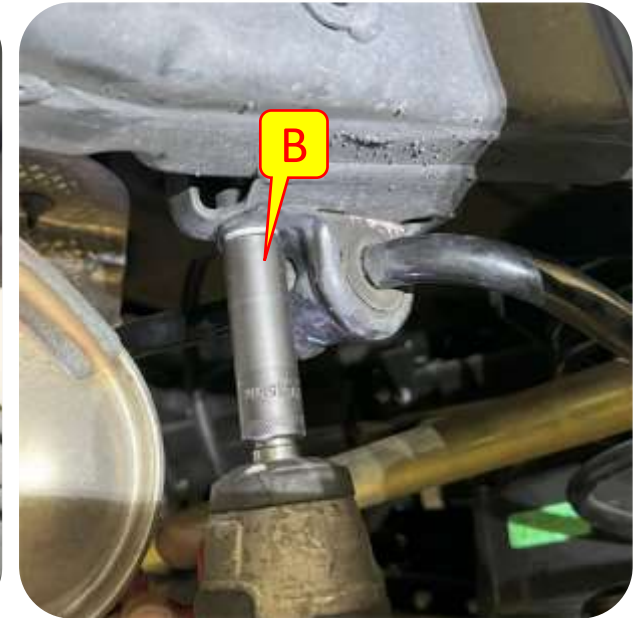

Note: *This skid is also compatible with the MetalCloak rear sway bar 4in drop bracket (7026), install the skid mount within the drop block, in the stock sway bar location using the stock bolts.*

Section 3: Installation Instructions

Step 2: Muffler Skid Installation

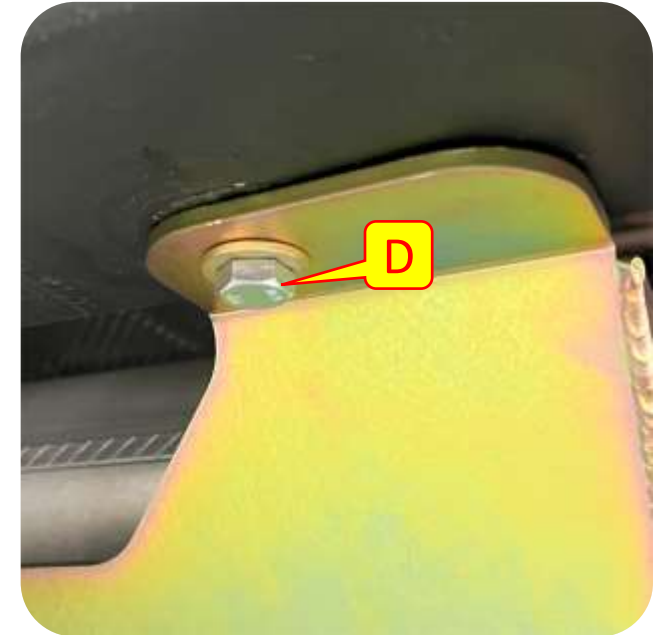

- D. Hold the muffler skid plate to the muffler and using a 17mm socket loosely install the provided bolts at the two rear bumper bolt locations
- E. Using a 9/16 socket and wrench loosely install the skid hangers to the skid plate.
- F. Tighten all hardware.

