



## PRODUCT: XJ Front Sway Bar Quick Disconnects 9”

REV: B | 06-25-2015 | II-7049

**READ INSTRUCTIONS IN FULL BEFORE INSTALLATION.**  
**QUESTIONS? CALL 916-631-8071 M-F 7:00 AM – 5:00 PM PST**

The MetalCloak experience includes the ease of installation of our products. We design for most contingencies, but installation may be different based on different Jeep condition, configuration and/or year.

We are continually trying to improve our products and instructions – please help us by providing feedback and pictures if you find any part of the instructions that do not match your particular Jeep or are not easily understandable.

If you have any difficulties at all, please give us a call. Thank you and enjoy your MetalCloak Products!

**IMPORTANT NOTE: We use Stainless Steel Hardware where possible. Therefore, a tube of Silver Anti-seize is provided and should be used on all bolts—only a small amount is needed.**

**WARRANTY INFORMATION:** This article is sold without warranty expressed or implied. No warranty or representation is made as to this products ability to protect the user from injury or death. The user assumes that risk. The effectiveness, warranty and longevity of this equipment are directly related to the manner in which it is INSTALLED, USED and/or MAINTAINED. THE USER ASSUMES ALL RISK. By purchasing this product and opening the packaging, purchasers expressly acknowledge, understand and agree that they take, select and purchase these MetalCloak products from Armored Works, LLC, its affiliates and distributors and agents as is and with all faults. The entire risk as to the quality and performance of these MetalCloak products is with the purchaser. Working on your vehicle can be a dangerous activity. If you are unsure of what you are doing, please leave mechanical or safety critical work to a skilled mechanic. We take no responsibility for the incorrect use and/or installation of MetalCloak products.

## Section 1: Tools & Notes on Installation



**Tools Required:** This list is the recommended tools for ease of installation. Other versions of the same tool can be used. For example, Allen Wrenches instead of Allen Drive Sockets. Be sure to use metric on metric and SAE on SAE.



Socket & Ratchet Wrench

19mm Socket



Drill

17/64" Drill Bit



15mm Box Wrench

Screw Driver (*optional*)

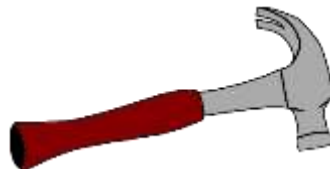

Hammer

**HOW TO USE THIS GUIDE:** The installation guide contains ALL steps for installation. Please read and follow the instructions in order of each page top to bottom, and left to right.

**Jeep Model:** Instructions may apply to multiple Jeep models, but are labeled separately where appropriate (i.e. TJ vs. LJ).

**Options:** Because of the number of component options we offer, these instructions may contain steps that will not match your particular configuration. You can skip these steps.

**Images:** Pictures are provided and parts are labeled throughout the instructions. Each text box contains guidance based on the pictures to it. The text will refer to alphabetical labels (A, B, etc) found in the images.

**Installation Notes:** Terms may be used in the body of the instructions that you may not be familiar with, if you have any questions feel free to contact us at the number below, or email [techhelp@metalcloak.com](mailto:techhelp@metalcloak.com)

**QUESTIONS:** Any questions or comments about the instructions? Call us at 916-631-8071 M-F 7:00 AM – 5:00 PM PST.

## Section 2: Product Components

DC-0001 REV A

SHEET 1 OF 1

ITEM	PART NUMBER/DESCRIPTION	QTY.
1	CP-3723 BRACKET, SWAY BAR DISCONNECT	1
2	CP-3723-P BRACKET, SWAY BAR DISCONNECT	1
E 3	FA-2067 WASHER, .4ID X 1.0OD X .09TH ZINC	2
4	FA-2068 HEX LOCK NUT, 0.38-16 X 0.33TH GR-C CAD PLTD	4
5	FA-2069 SHOULDER BOLT, 0.5D X 1.75L, .38-16 X .63L THREAD	2
6	FA-2070 HHCSCREW .375-16 x 2.0L GR8 ZINC	2
7	SS-0040-022 SPACER, SHOCK MOUNT .5 ID X .75 OD	2
8	SS-1089 SWAY BAR ADAPTER BLOCK	1
9	SS-1089-P SWAY BAR ADAPTER BLOCK	1
10	SS-1094 SWAY BAR QUICK DISCONNECT, XJ 9 INCH	1
D 11	SS-1095 SPACER, SWAY BAR, XJ	2

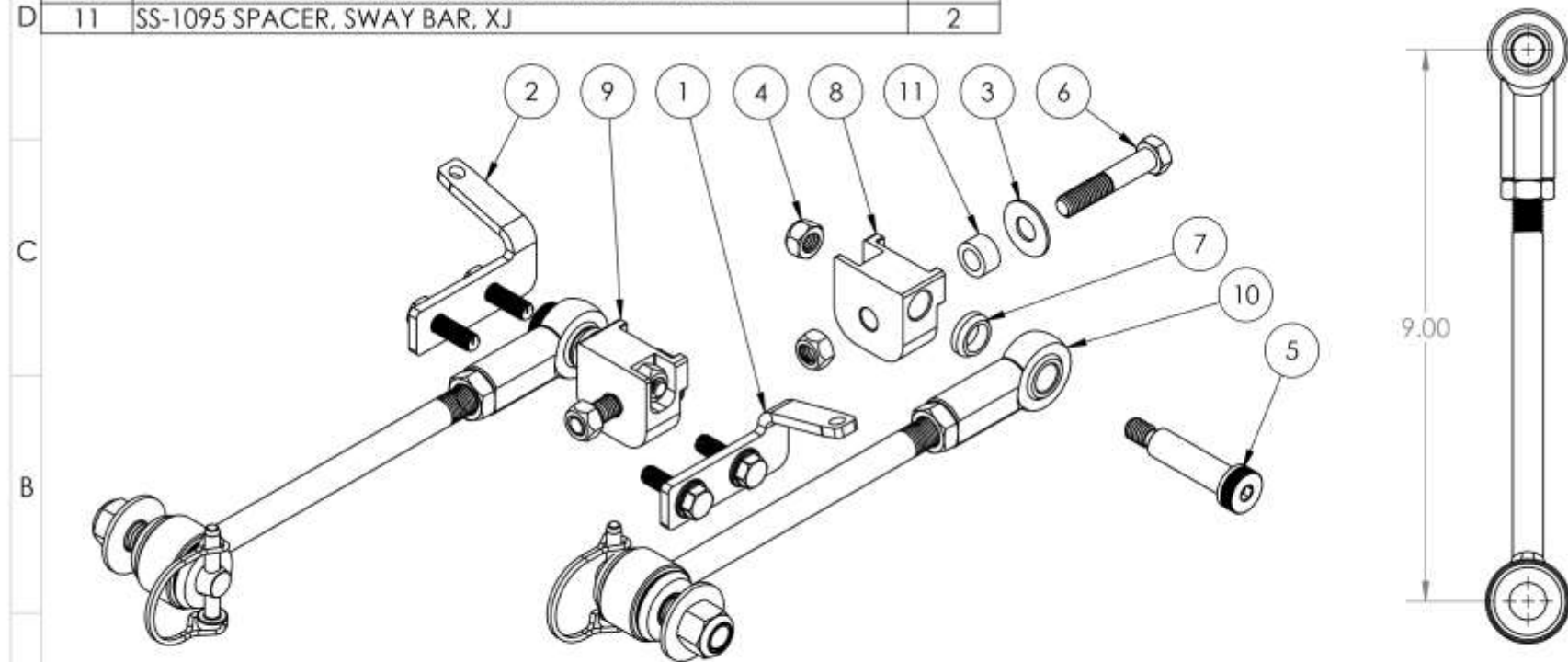

A

THE INFORMATION CONTAINED ON THIS DRAWING IS THE EXCLUSIVE PROPERTY OF ARMORED WORKS, LLC. UNAUTHORIZED REPRODUCTION IS PROHIBITED. DO NOT SCALE DRAWING

**Metal Cloak**  
A DIVISION OF ARMORED WORKS, LLC

PART NUMBER DESCRIPTION 7049 SWAY BAR QUICK DISCONNECT, 9 INCH, XJ FRONT

## Section 3: Installation Instructions



### Step 1: Remove Stock Sway Bar

- A. Remove front sway bar end links. Using a 19mm wrench and a 15mm wrench for the upper nut.
- B. Remove factory sway bar stud. In some year models these are wedged in place and may need additional force to remove.

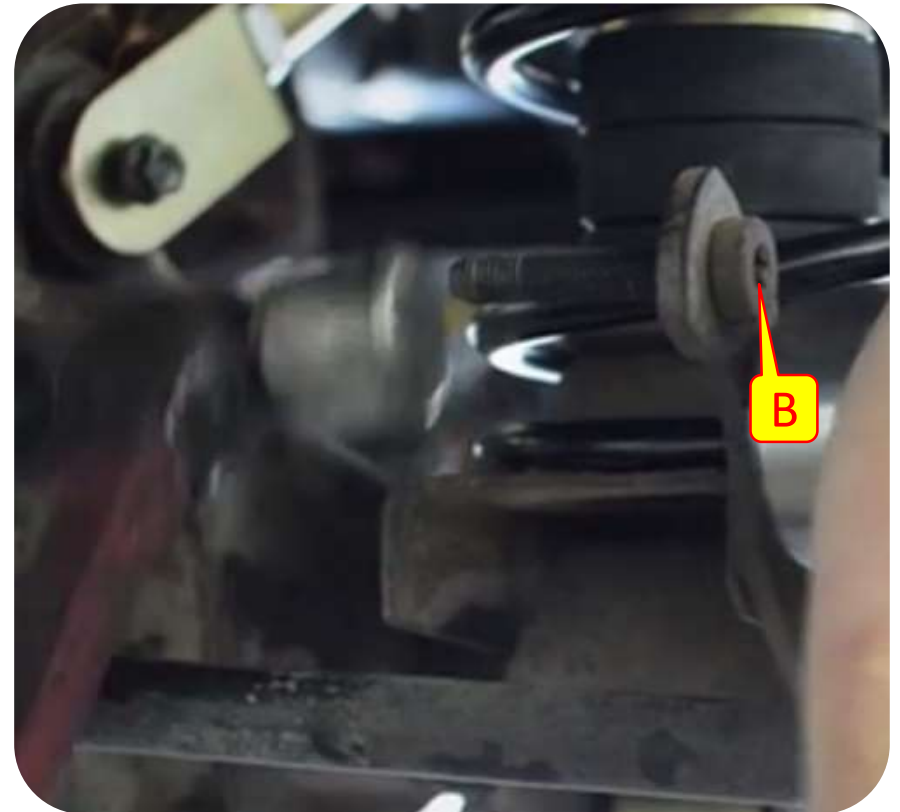
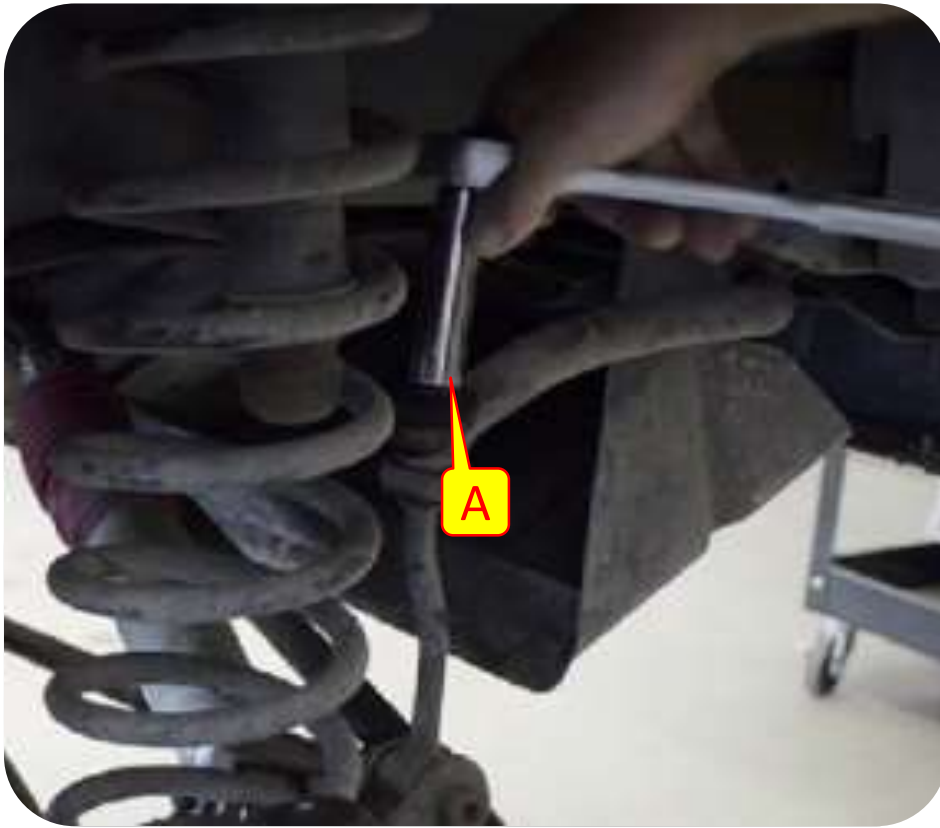



## Section 3: Installation Instructions



### Step 2: Install Sway Bar Quick Disconnects

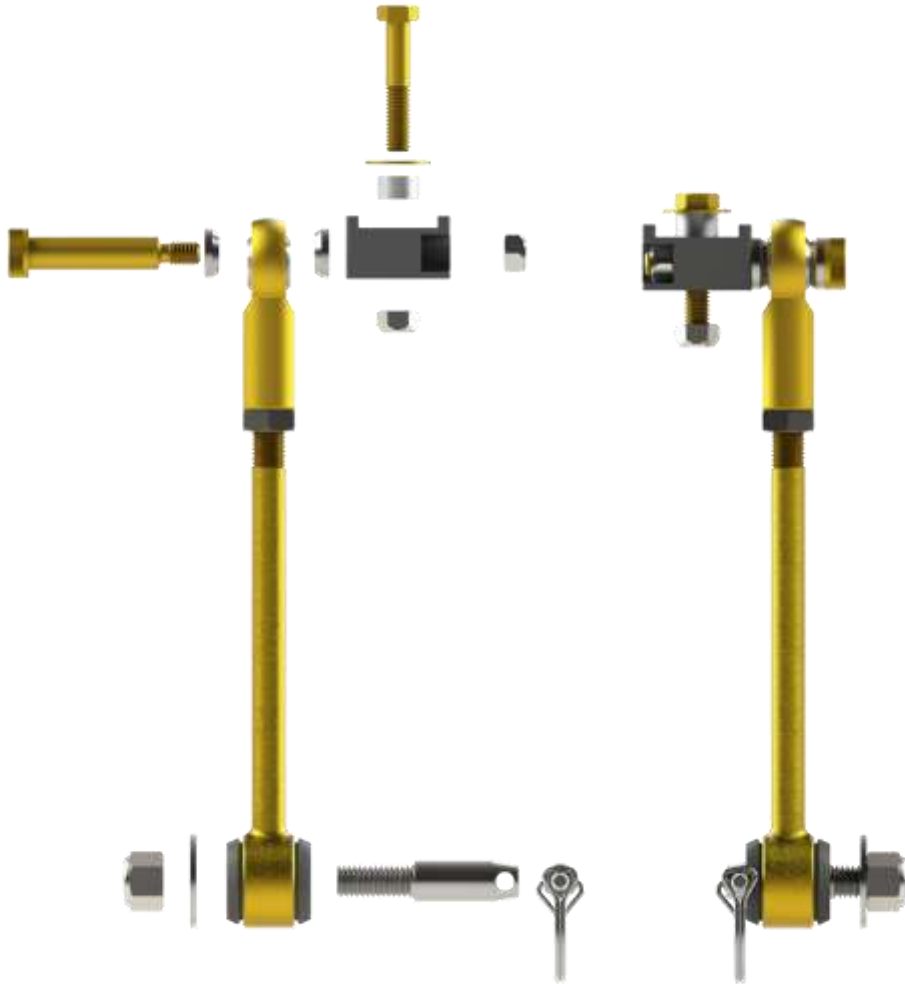

- C. Install the lower Quick Disconnect Pin in the stock location. Point the Pin toward the center of the vehicle, backed by the provided  $\frac{1}{2}$ "-13 hardware. A screwdriver through the hole on the end of the Pin is helpful while tightening the nut with a  $\frac{3}{4}$ " wrench.
- D. Adjust the length of the adjustable links to set the sway bar at the desired length (usually level to the ground at ride height). With the lower rubber bushing installed on the Quick Disconnect Pin, tighten the jam nut.



## Section 3: Installation Instructions

### Step 2: Install Sway Bar Quick Disconnects

- E. Install front sway bar end link mounts.
- F. Mark and drill holes for bracket. There is no exact location; the goal is simply to keep the sway bar clear of the tires when stowed. Mark the locations and drill with a 17/64" drill.
- G. Install new sway bar link mounts.
- H. Install new sway bar links.

