



PRODUCT: Maximus Gaming Station Installation

REV: A | 04-06-2023 | II-PB1004

**READ INSTRUCTIONS IN FULL BEFORE INSTALLATION.
QUESTIONS? CALL 916-631-8071 M-F 7:00 AM – 5:00 PM PST**

The PatriotBilt experience includes the ease of installation of our products. We design for most contingencies, but installation may vary.

We are continually trying to improve our products and instructions – please help us by providing feedback and pictures if you find any part of the instructions that do not match your particular installation or are not easily understandable.

If you have any difficulties at all, please give us a call. Thank you and enjoy your PatriotBilt Products!

WARRANTY INFORMATION: This article is sold without warranty expressed or implied. No warranty or representation is made as to this products ability to protect the user from injury or death. The user assumes that risk. The effectiveness, warranty and longevity of this equipment are directly related to the manner in which it is INSTALLED, USED and/or MAINTAINED. THE USER ASSUMES ALL RISK. By purchasing this product and opening the packaging, purchasers expressly acknowledge, understand and agree that they take, select and purchase these PatriotBilt products from Armored Works, LLC, its affiliates and distributors and agents as is and with all faults. The entire risk as to the quality and performance of these PatriotBilt products is with the purchaser. Working on your vehicle can be a dangerous activity. If you are unsure of what you are doing, please leave mechanical or safety critical work to a skilled mechanic. We take no responsibility for the incorrect use and/or installation of PatriotBilt products.

Section 1: Tools & Notes on Installation

Tools Required: This list is the recommended tools for ease of installation. Other versions of the same tool can be used. For example, Allen Wrenches instead of Allen Drive Sockets.



Socket & Ratchet Wrench

9/16" Socket
11/32" Socket



Philips Screwdriver

7/32" Allen Wrench



HOW TO USE THIS GUIDE: The installation guide contains ALL steps for installation. Please read and follow the instructions in order of each page top to bottom, and left to right.

Options: Because of the number of component options we offer, these instructions may contain steps that will not match your particular configuration. You can skip these steps.

Images: Pictures are provided, and parts are labeled throughout the instructions. Each text box contains guidance based on the pictures next to it. The text will refer to alphabetical labels (A, B, etc.) found in the images.

Installation Notes: Terms may be used in the body of the instructions that you may not be familiar with, if you have any questions feel free to contact us at the number below.

QUESTIONS: Any questions or comments about the instructions? Call us at 916-631-8071 M-F 7:00 AM – 5:00 PM PST.

Section 2: Product Components



DC-0001 Rev B

SHEET 1 OF 2

ITEM	PART NUMBER/DESCRIPTION	QTY.
1	DS-0035 SHEET, HANGER RAIL	4
2	DS-0042 SHEET, POWER STRIP MOUNT	1
3	DS-0044 SHEET, CABLE ORG TRAY	2
4	DS-0045 HEADPHONE HANGER	12
5	DS-0046 MAGNETIC REMOTE HOLDER	4
6	DS-0048 RETENTION STRAP	4
7	FA-1111 MONITOR MOUNT	4
8	FA-1114 POWER SUPPLY, 8 POSITION RACK MOUNT	1
9	WM-9004 WELDMENT, UPPER LEG, MAXIMUS	4
10	WM-9005 WELDMENT, LOWER LEG, MAXIMUS	4
HK-PB1004		
11	DS-0047 ADHESIVE FURNITURE FOOT, 1.75D	4
12	FA-1005 ZIP TIE DOUBLE LOCK, 8IN, UV BLACK	20
13	FA-1011 ZIP TIE DOUBLE LOCK, 8IN, UV RED	6
14	FS-01017 FHCS CROSS, 8-32 X 0.50L 18-8 SS BLACK OXIDE	24
15	FS-01019 NYLOCK NUT, 8-32 X 0.23H STL GF ZINC	24
16	FS-03023 PHCS CROSS, 12-24 X 0.50L SS 18-8 PASSIVATED	10
17	FS-06001-BZ SBHCS, 0.38-16 X 0.75L STL G5 BLACK ZINC	40
18	FS-06053 SERRATED FLANGE LOCK NUT, 0.38-16 X 0.34H STL GF ZINC	40

- OPTION 1:
DUAL GAME SYSTEM KIT - PB1021
- OPTION 2:
ETHERNET KIT - PB1022
- OPTION 3:
TV MOUNT EXTENDER KIT - PB1023

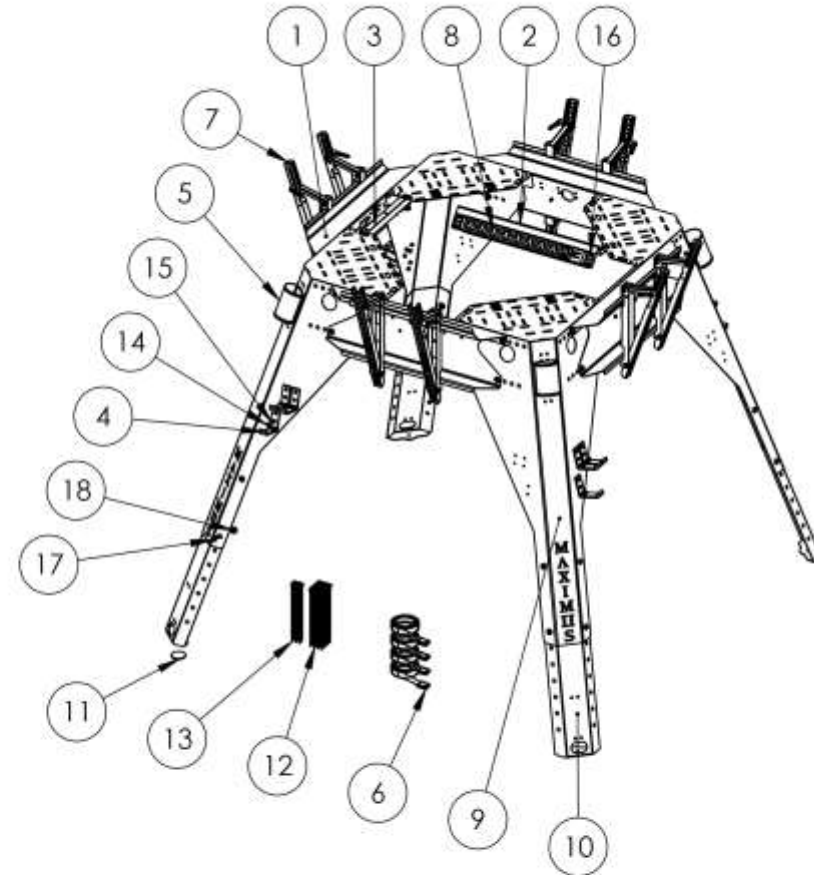

THE INFORMATION CONTAINED ON THIS DRAWING IS THE EXCLUSIVE PROPERTY OF ARMORED WORKS, LLC. UNAUTHORIZED REPRODUCTION IS PROHIBITED.

DO NOT SCALE DRAWING



PART NUMBER/DESCRIPTION

PB1004 MAXIMUS GAMING STATION

Section 3: Installation Instructions

Step 1: Maximus System Assembly

Important Note: *It is easiest to build the system upside-down.*

Important Note: *Do Not tighten down the hardware until all the upper legs and rails are together.*

A. Using a 7/32 allen wrench and a 9/16" socket attach the tv rails to the upper leg sections with the 3/8" hardware.

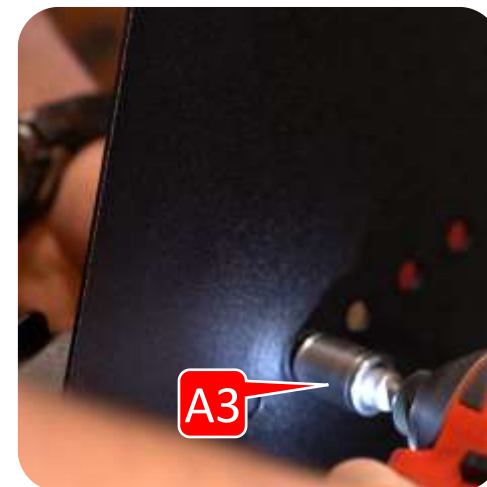

Section 3: Installation Instructions

Step 1: Maximus System Assembly

- B. Attach the lower legs to the upper legs using the same 3/8" hardware to your desired height.
- C. Affix the adhesive furniture sliders to the bottom of the lower legs.
- D. Tighten all the hardware using a 7/32" allen wrench and a 9/16" socket.
- E. Enlist a friend's help or coerce an enemy to flip the system right side up.



Section 3: Installation Instructions

Step 2: Power Supply (Option 1 – With Ethernet Kit)

Important Note: If you did not order the optional ethernet kit the following instructions are not necessary for your install. Continue to page 8.

- F. Insert the 8-32 carriage bolts in the mounting holes through the bottom of the bracket and loosely thread the matching nuts onto them.
- G. Install the switch to the bracket by sliding the carriage bolt heads into the mounting grooves on the switch and tightening the nuts with a 11/32" socket.

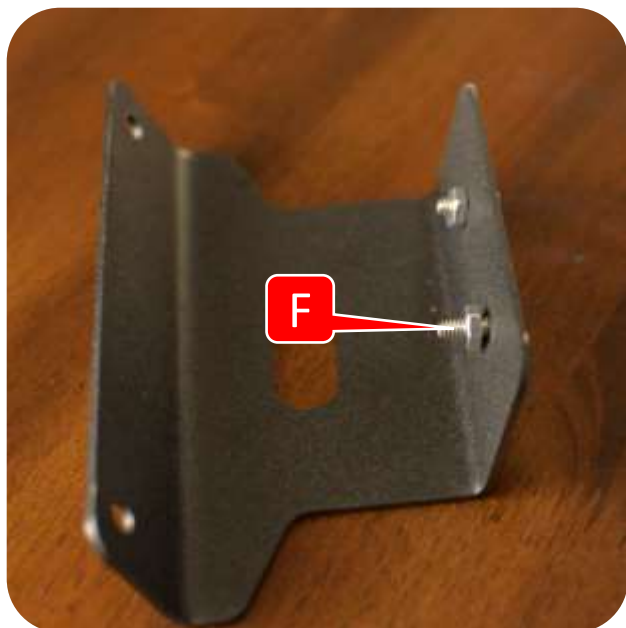

Section 3: Installation Instructions

Step 2: Power Supply (Option 1 – With Ethernet Kit)

- H. Install the net switch bracket between the Maximus tv mount rail and the power strip bracket. using the power strip bracket screws and tighten down when done.

H2 Power Strip Bracket

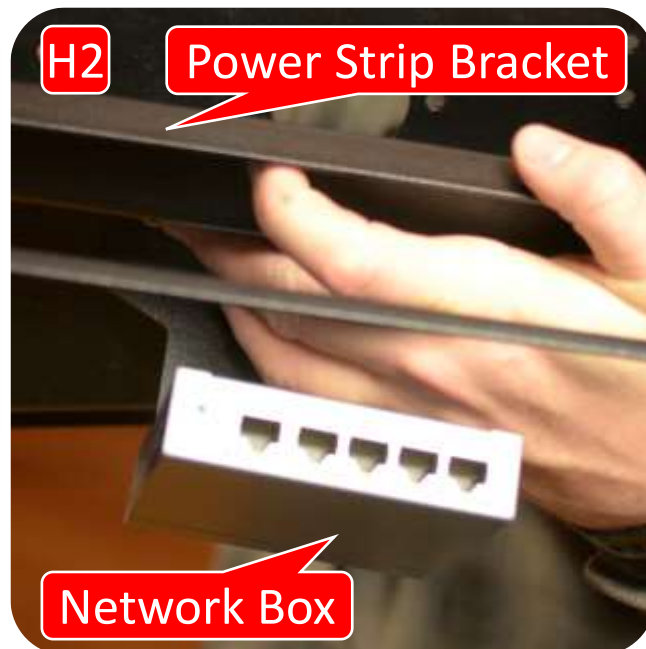

Network Box



H3

Outside of Maximus Bolt Locations

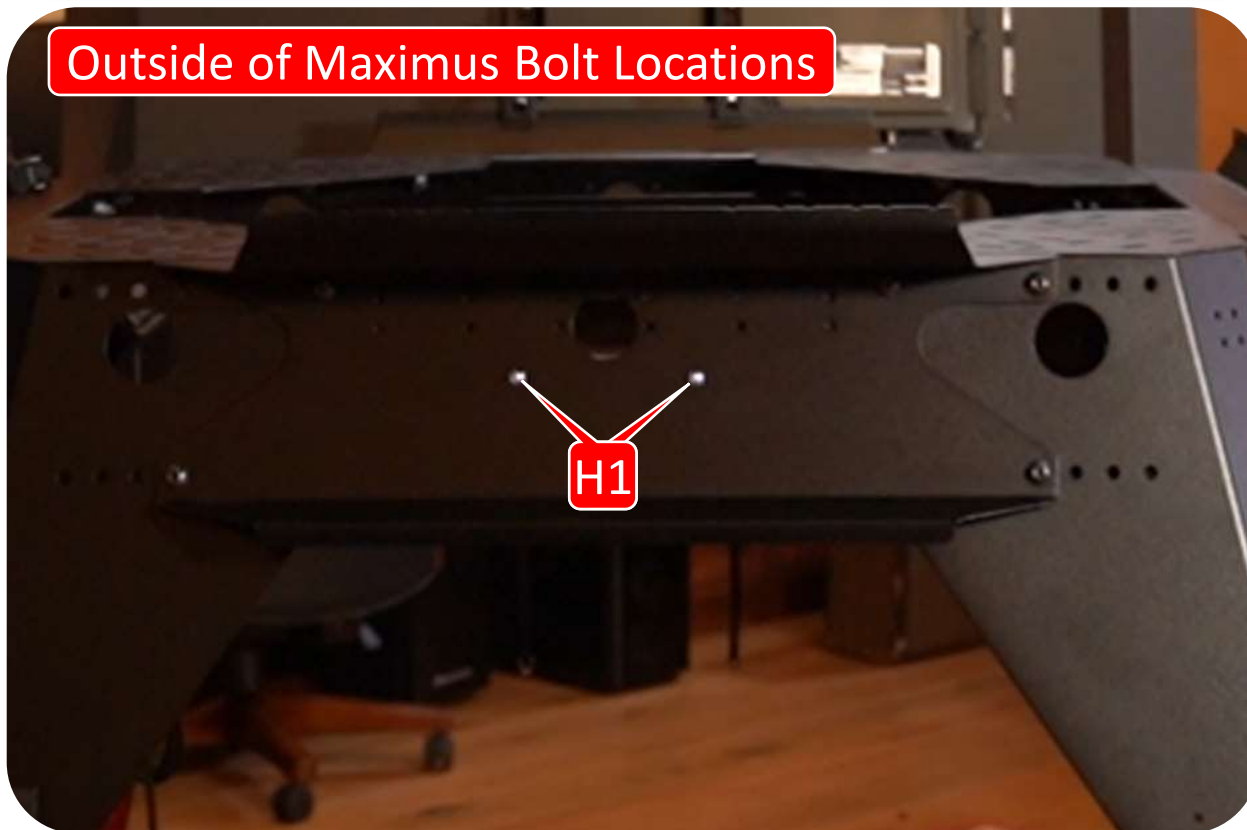

H1

Section 3: Installation Instructions

Step 2: Power Supply (Option 2 – Without Ethernet Kit)

- I. Attach the power supply to the provided power supply bracket using the provided #12 pan head screws.
- J. Attach the cord trays mount to the backside of the tv rails with the provided #12 pan head screws. We recommend mounting the power supply mount to the section closest to the outlet you will be using.

Important Note: If you ordered the dual game system option you will need to install the second power supply bracket to one of the other rails of your choosing.

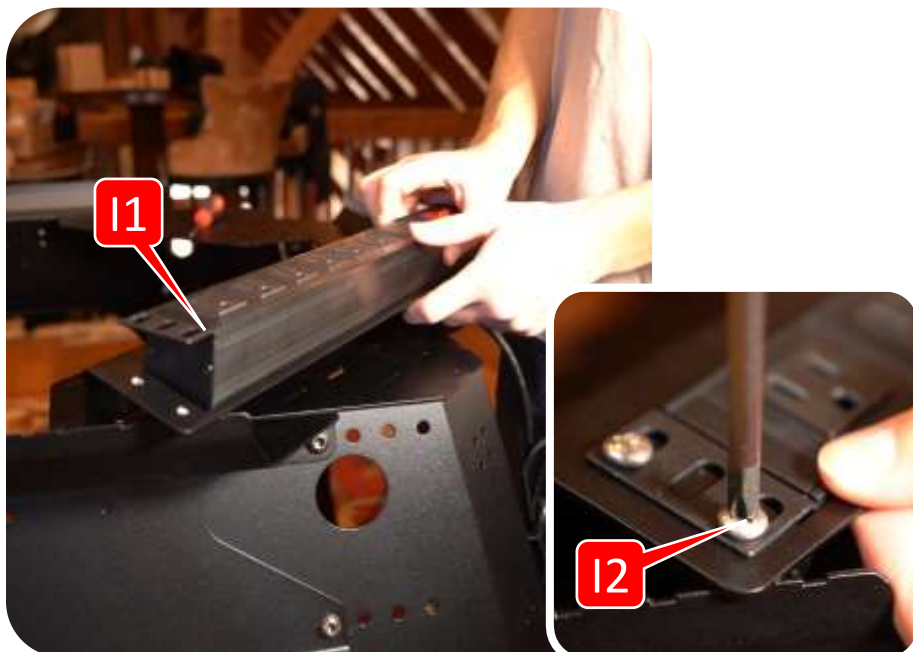
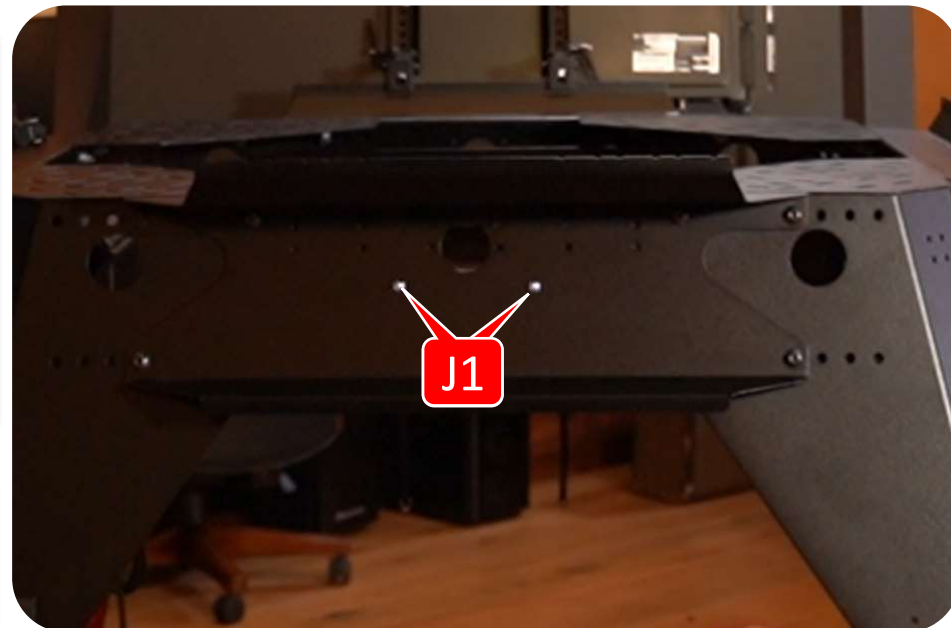

Section 3: Installation Instructions

Step 3: Headset and Controller Mounts

- K. Attach the headset and controller mounts to the legs with the provided #8 flathead screws and matching nuts.
- L. Tighten the headset and controller mounts using a Philips head screwdriver and 11/32" socket.

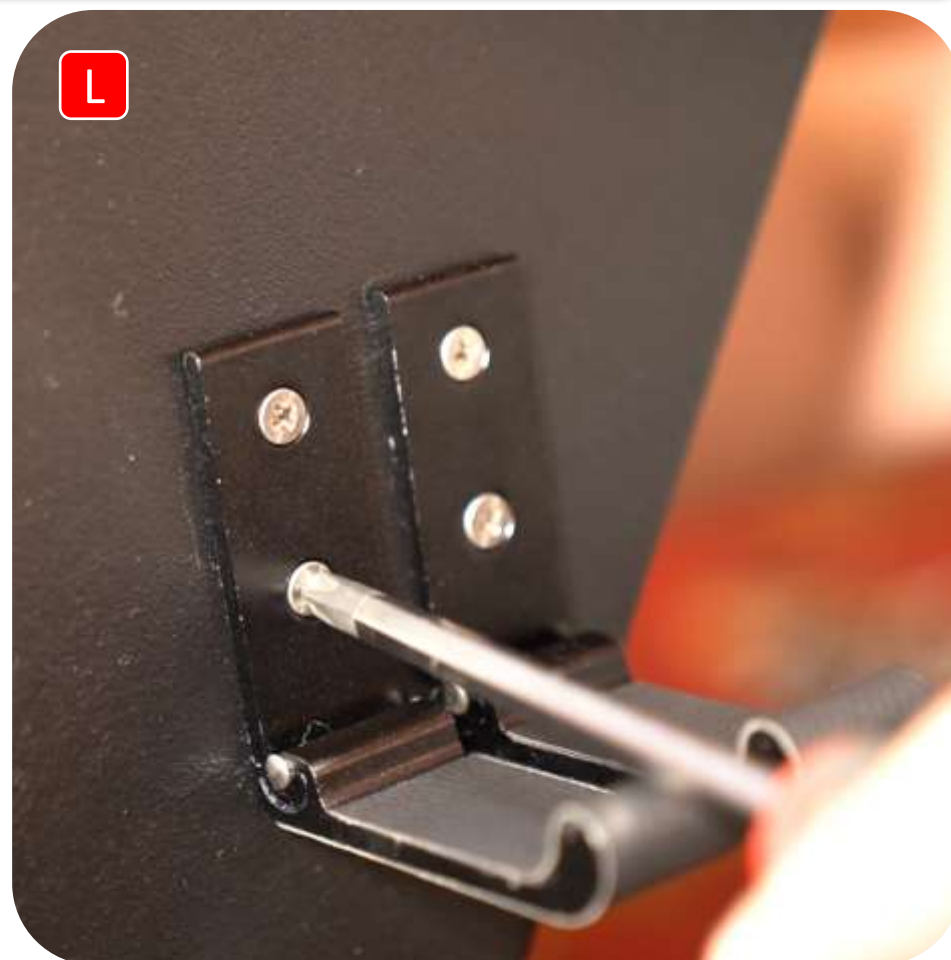

Section 3: Installation Instructions

Step 4: TV Mount Brackets (Option 1 – With Extenders)

Important Note: *If you did not order the optional tv extenders the following instructions are not necessary for your install. Continue to page 11.*

- M. If you ordered the tv mount extender brackets, first attach those to the tv mount brackets with the 1/4-20 flathead screws and matching flange nuts (M1). Mount the TV's bracket to the tv (M2) and as close as possible so the bottom of the bracket would be even with the bottom of the tv (M3).

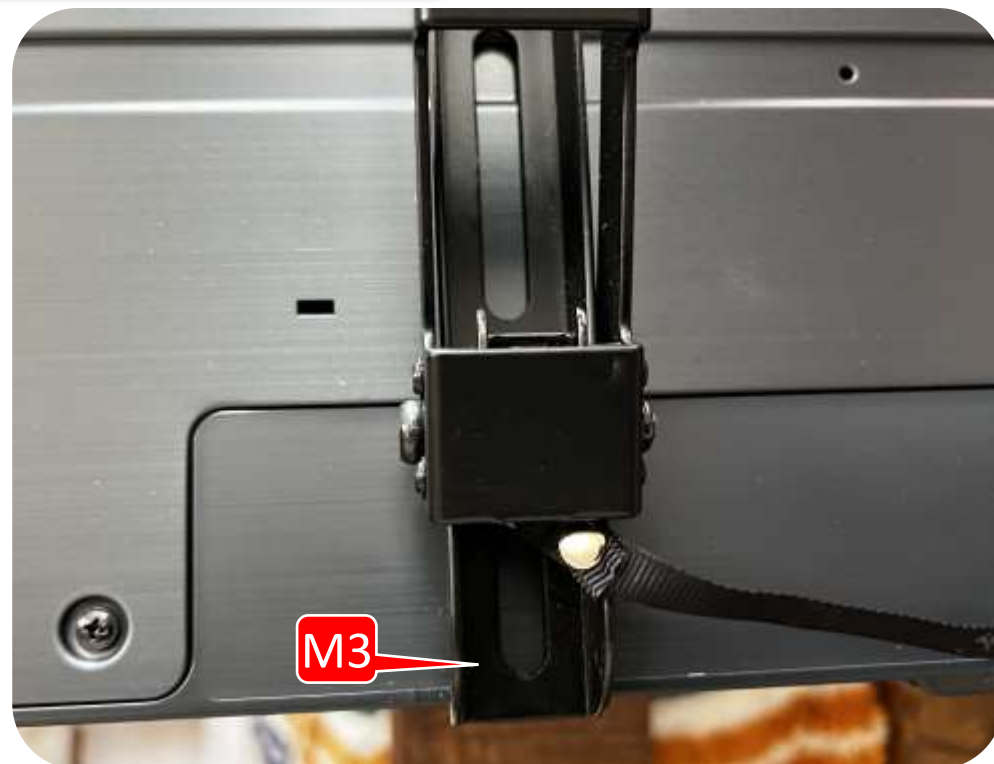
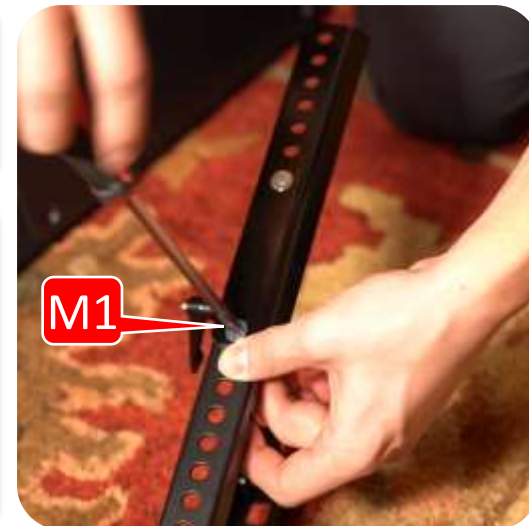

Section 3: Installation Instructions

Step 4: TV Mount Brackets (Option 2 – Without Extenders)

- N. Use the tv mounting hardware to attach the tv mount brackets to the back of the TV's (N1). Mount them as close as possible so the bottom of the bracket would be even with the bottom of the tv (N2).

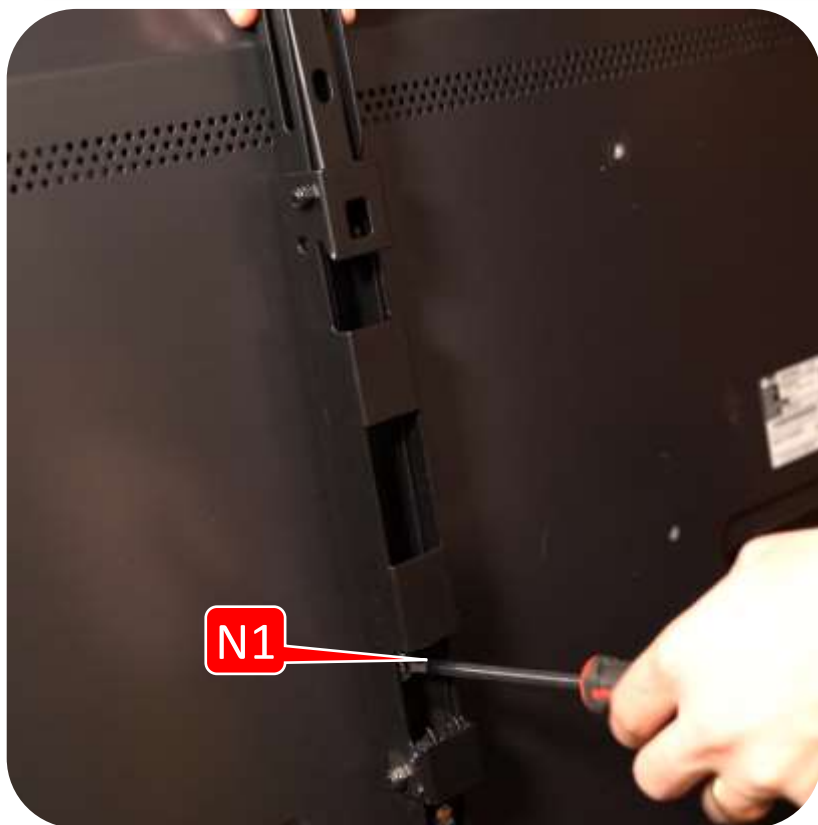

Section 3: Installation Instructions

Step 5: Attach Gaming Console to Maximus (Xbox Console)

- O. Place and secure the game consoles to the upper legs' platforms by passing the straps through the slots on the platforms (O1) and tightening them down (O2).



Section 3: Installation Instructions

Step 5: Attach Gaming Console to Maximus (PlayStation Console)

- P. Slide the provided straps between the console and console stand.
- Q. Place and secure the game console to the upper legs' platforms by passing the straps through the slots on the platforms and tightening them down.



Section 3: Installation Instructions

Step 6: Install the TVs

- R. Install the tv's by hanging the tv mount brackets on the tv mount rail. The bottom of the mount bracket should click in to keep it secured.
- S. Wire everything up. You can use the zip tie attachment holes to securely route wires throughout the system.

Note: *If you purchased the Network Kit Option you will need to install the provided plug into the power strip to that you have enough plugs for the network device.*

